

L2D4-500

by CMC

Catalog ID: L2D4-500

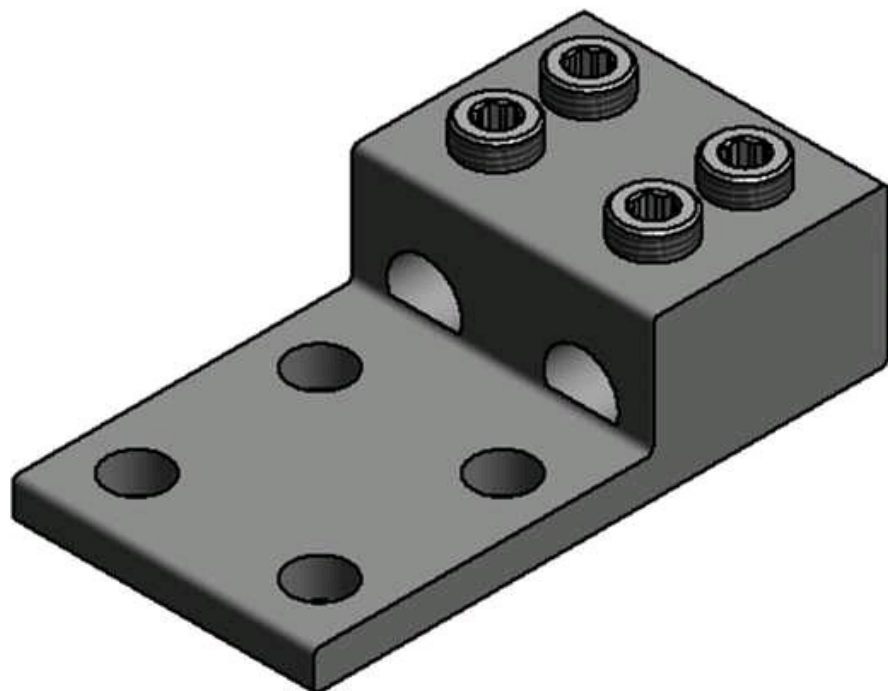

Heavy-duty transformer connectors, uni-joint, Dual rated connectors for Aluminum or Copper conductors, CO-OX Oxide inhibitor is omitted

- Clear Plated for low-contact resistance
- Fully tested to ANSI C119.4 for Class 'A' connectors
- Supplied with aluminum radial tipped set-screws
- Connector fabricated from 6061-T6 aluminum alloy for conductivity and strength
- Designed for installation on standard two and four-hole spades
- All mounting holes 1.75" on center line
- For installation, CMC® recommends the use of a 9" insulated Allen wrench
- A torque wrnch should be used to ensure the proper torque is achieved

Product Details

General

Type	Bolted Lugs & Terminals
UPC	192663011674