



LTC-4SQD

LITEISTRY 4" SQUARE CYLINDER

FEATURES

- 4" architectural LED downlight cylinder delivering 600 - 4000 lm
- Four beam distributions from 0.6 to 1.2 Spacing Criteria
- Quiet reflector appearance with 50° optical cutoff
- 2700K - 5000K, 80+ and 90+ CRI options
- Available in Surface, Wall, Pendant or Cord Mount configurations
- Variety of dimming protocol options including 0-10V, DALI, DMX, Forward Phase and EcoSystem



(Select Models)



See Certification Specifications

CONTROL TECHNOLOGY



SPECIFICATIONS

CONSTRUCTION

- Seamless heavy gauge aluminum cylinder body with a clean appearance
- Select from 4 durable powder coat paint architectural finishes or Brushed Aluminum
- Available in Surface, Wall, Pendant, or Cable/Cord mounting options
- Wall Mount: One piece die cast aluminum mounting arm
- Wall Mount driver is integral in cylinder
- Pendant Mount: Swivel canopy allows sloped ceiling mounting up to 45 degrees
- Integral driver versions allow direct mounting to a standard 4" octagonal or square junction box
- Some configurations require remote mount driver assembly (see line art)

OPTICS

- Visually pleasing 50° cutoff to source and source image
- The light distribution is free of distracting bright spots or pixelation and the perimeter has a smooth transition
- Optical grade silicone lens integral to light engine
- High purity four panel aluminum reflector, self-flanged
- Large selection of anodized finishes and colors

OPTICS (CONTINUED)

- Painted cones and flange options available

ELECTRICAL

- Chip-on-board LED with 2 SDCM
- Multiple CCTs, 80+ or 90+ CRI
- Long LED life: L90 at >55,000 (TM-21)
- Universal voltage 120V-277V driver, 347V optional
- UL Class 2, inherent short circuit and overload protection, RoHS compliant
- Flicker free 0-10V dimming with 1% or < 1% performance
- DALI, DMX, and Lutron Forward Phase and EcoSystem options

INSTALLATION

- Light Engine/Trim assembly is mechanically secured with torsion springs for ease of installation
- A quick connect is provided for easy maintenance or upgrade
- Remote mount driver/jbox assembly requires 6" plenum clearance
- Remote driver is accessible from above or below the ceiling

LITEISTRY™



RELATED PRODUCTS

Ø 3" LITEISTRY Family

Ø 4" LITEISTRY Family

Ø 6" LITEISTRY Family

CERTIFICATIONS

- cCSAus certified to UL 1598
- Wall Mount up to 30L: Suitable for wet locations
- Pendant Mount up to 30L: Suitable for wet locations under covered ceiling
- Surface, Cord Mount and all 35L-40L: Suitable for damp locations
- This product qualifies as a "designated country construction material" per FAR 52.225-11 Buy American-Construction. Materials under Trade Agreements effective 6/6/2020. See [Buy American Solutions](#).

WARRANTY

- 5 year warranty
- See [HLI Standard Warranty](#) for additional information

KEY DATA	
Lumen Range	600-4000
Wattage Range	8-52
Efficacy Range (LPW)	89-99*
Reported Life (Hours)	L90 / >55,000
Input Current Range (mA)	67-433 (120V)

*Based on Specular, 35K, 80 CRI



LTC-4SQD

LITEISTRY 4" SQUARE CYLINDER

DATE:	LOCATION:
TYPE:	PROJECT:
CATALOG #:	

ORDERING GUIDE

Example: LTC-4SQD-P-15L35K9WD-DM1-SS-WH

CATALOG #

LTC-4SQD						
Aperture/Shape/Function	Cylinder Mounting	Lumen Output	CCT	CRI	Distribution	
LTC-4SQD 4" Square Downlight Cylinder	S Surface W Wall P Pendant (18" Stem Standard) CM Cable/Cord (6 ft. Cord Standard) ⁵	06L 600 Lumens 10L 1000 Lumens 15L 1500 Lumens 20L 2000 Lumens 25L 2500 Lumens 30L 3000 Lumens 35L 3500 Lumens ⁸ 40L 4000 Lumens ⁸	27K 2700K 30K 3000K 35K 3500K 40K 4000K 50K 5000K ¹	8 80+ CRI 9 90+ CRI	NR Narrow (0.6 SC/37°) MD Medium (0.8 SC/46°) WD Wide (1.0 SC/60°) XW Extra Wide (1.2 SC/69°)	

Driver Options	Control Options	Voltage	Reflector Finish	Reflector Color	Flange Color Options
DM1 0-10V Dimming to 1% ³ DM01 0-10V Dimming to <1% ³ DMX DMX with RDM dimming to <0.1% ^{3,7} DALI DALI Dimming to 1% ³ 2DM Lutron Hi-Lume 2-wire Dimming to 1% (120V Forward Phase only) ³ EDM Lutron Hi-Lume EcoSystem Dimming to 1% ³	NXE NX, Dual SmartPORTs ^{2,3,7} NXWE NX Wireless Enabled ^{2,3,7} NXWD NX Wireless, Dual SmartPORTs ^{2,3,7} LV Lutron Vive Enabled, 0-10V (requires DM1 driver) ^{3,7} LVE Lutron Vive Enabled, EcoSystem, (requires EDM) ^{3,7}	Standard 120-277V 34 347V ^{3,6}	<i>Finish not applicable with painted reflectors (WC or BC)</i> S Specular SS Semi-Specular VS Softglow® VSS SoftSheen™	Standard Clear CG Champagne Gold BL Black LW Light Wheat PW Pewter WC Painted White Cone and Flange BC Painted Black Cone and Flange	Standard matches reflector color WT White Flange ⁴ BT Black Flange ⁴

Exterior Cylinder Color

BA	Brushed Aluminum
BZ	Bronze
BL	Matte Black
WH	Matte White
SVR	Silver

Notes:

- 1 5000K is available in 80+ CRI only.
- 2 NX requires DM1 driver option.
- 3 For lumen outputs/configurations available, see chart on page 3.
- 4 WT not needed for WC; BT not needed for BC.
- 5 CM standard cord color is Clear.
- 6 347V requires DM1 driver options; not available with Controls.
- 7 Controls not available on Wall mount (W).
- 8 35L and 40L require vented cylinder.



LTC-4SQD

LITEISTRY 4" SQUARE CYLINDER

DATE:	LOCATION:
TYPE:	PROJECT:
CATALOG #:	

DRIVER/CONTROL OPTION AVAILABILITY

Driver and Control options listed below are available in the configurations and lumen packages as shown.

Driver/Control Option		Cylinder Mounting ¹	Integral Remote Driver ¹	06L	10L	15L	20L	25L	30L	35L	40L
DM1	0-10V 1%	W	Integral	●	●	●	●	●	●	▼	▼
		S/P/CM	Integral	●	●	●	●	●	●	▼	▼
DM01	0-10V <1%	W	Integral	●	●	●	●	●			
		S/P/CM	Integral	●	●	●	●	●			
DALI	DALI 1%	W	Integral	●	●	●	●	●			
		S/P/CM	Integral	●	●	●	●	●			
DMX	DMX w/ RDM <0.1%	W	Integral		●	●	●	●	●		
		S/P/CM	Remote (IC Rated)		●	●					
2DM	Lutron Hi-Lume 2-wire 1%	W	Integral		●	●	●				
		S/P/CM	Integral		●	●	●				
EDM	Lutron Hi-Lume EcoSysytem 1%	W	Integral		●	●	●				
		S/P/CM	Integral		●	●	●	●			
347V ³	347 Volts (DM1 required)	W	Integral		●	●	●	●	●	▼	▼
		S/P/CM	Integral		●	●	●	●	●	▼	▼

NX (All)	NX (DM1 required)	W	N/A								
		S/P/CM	Remote (Non-IC)	●	●	●	●				
LV	Lutron Vive® (DM1 required)	W	N/A								
		S/P/CM	Remote (IC Rated)	●	●	●	●				
LVE	Lutron Vive® (EDM required)	W	N/A								
		S/P/CM	Remote (Non-IC)		●	●	●				

▼ Vented cylinder required, see line art for more details.

¹ See Cylinder Mounting chart for details.

² See line art for more details.

³ Not available with Controls.

Cylinder Mounting	
W	Wall Mount
S	Surface Mount
CM	Cable/Cord Mount
P	Pendant Mount

CONTROLS

NX Distributed Intelligence™ Lighting Controls:

Supports applications in a variety of deployment options- wired, wireless, hybrid. Integrates with and enables a wide array of luminaires including those with SpectraSync™ Color Tuning Technology.



NX INTEGRATED CONTROLS REFERENCE								
NX Option	Sensor	Networkable	Scheduling	Occupancy	Daylight Harvesting	0-10V Dimming	On/off Control	Bluetooth® App Programming
NX Networked – Wired								
NXE	N/A	Yes	Yes	No	No	Yes	Yes	Requires NXBTC/R ¹
NX Networked – Wireless								
NXWE ²	N/A	Yes	Yes	No	No	Yes	Yes	No ³
NX Networked – Wired/Wireless								
NXWD	N/A	Yes	Yes	No	No	Yes	Yes	Requires NXBTC/R ^{1,3}

¹ NXBTC/R needs to be plugged into an available NX SmartPort™ on the fixture network

² Programming via App requires factory assistance

³ To program NXWE option, need to consult factory. If connected to an area controller, programming can be done from that

DIMENSIONS

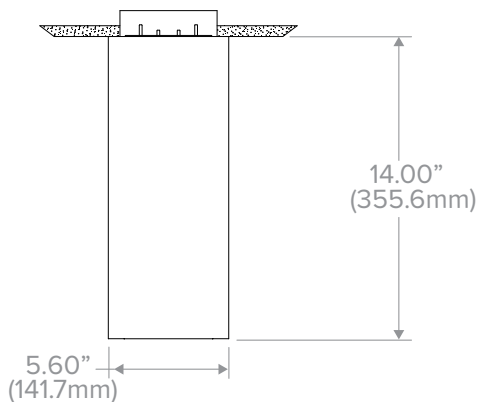

Integral Driver

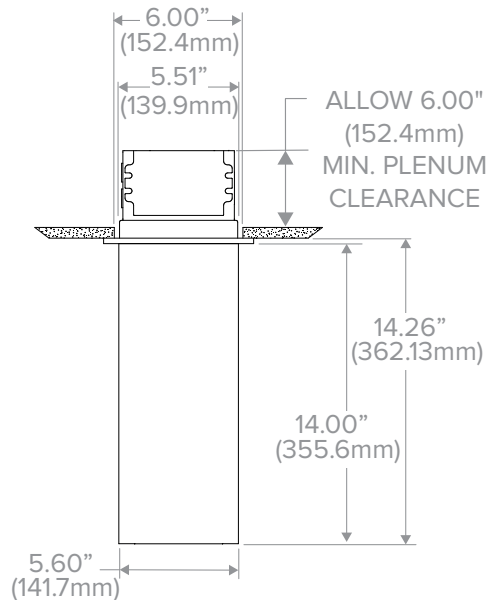

Remote Driver
For DMX, all NX or Lutron Vive Controls

Surface (-S)

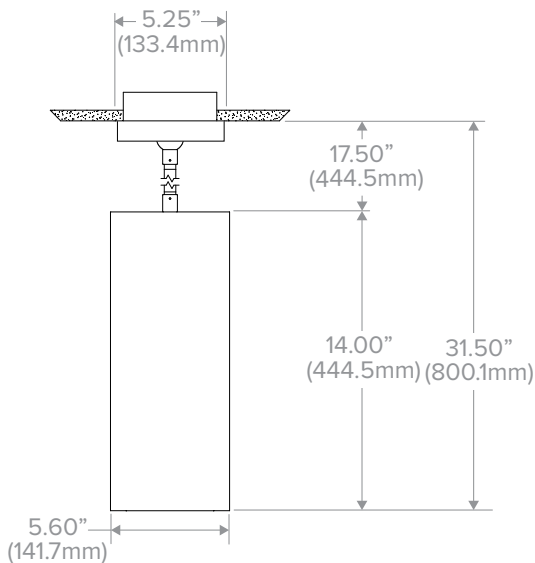

Integral Driver

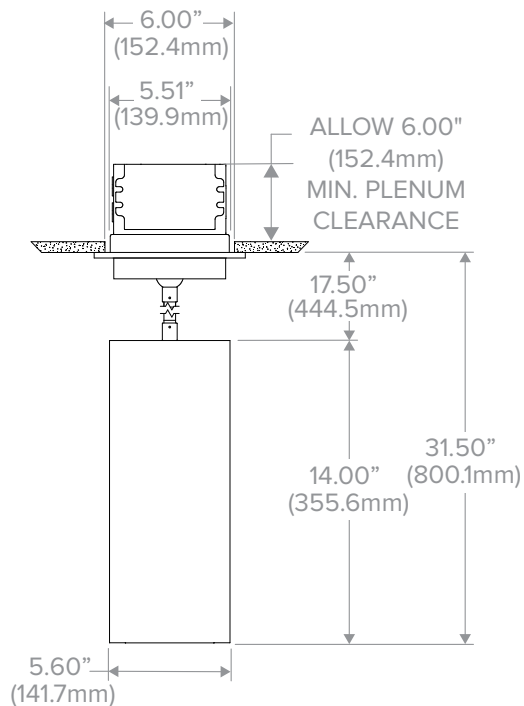

Remote Driver
For DMX, all NX or Lutron Vive Controls

Pendant (-P)

DIMENSIONS (CONTINUED)

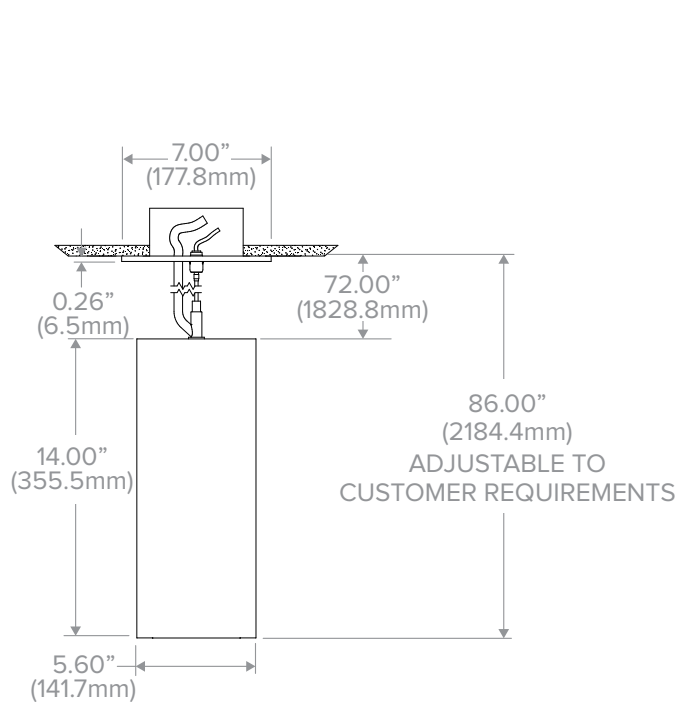

Integral Driver

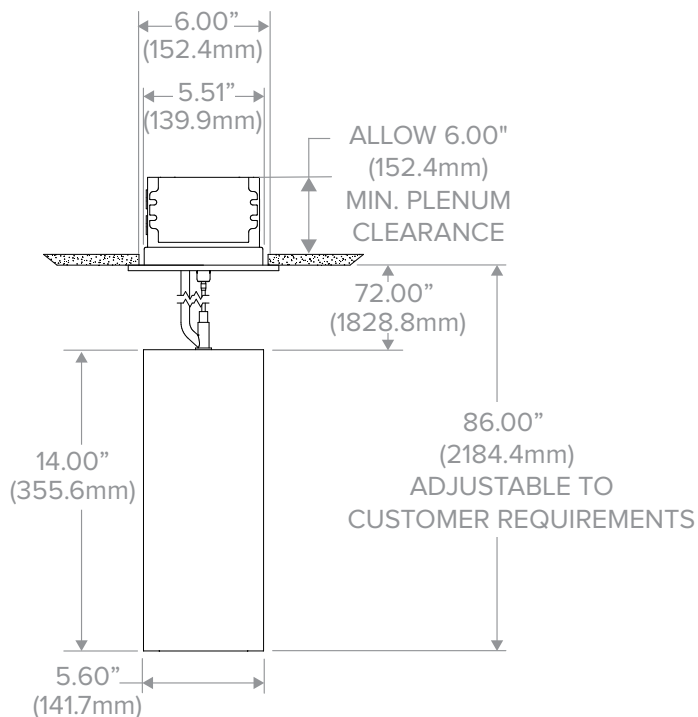

Remote Driver
For DMX, all NX or Lutron Vive Controls

Cord (-CM)

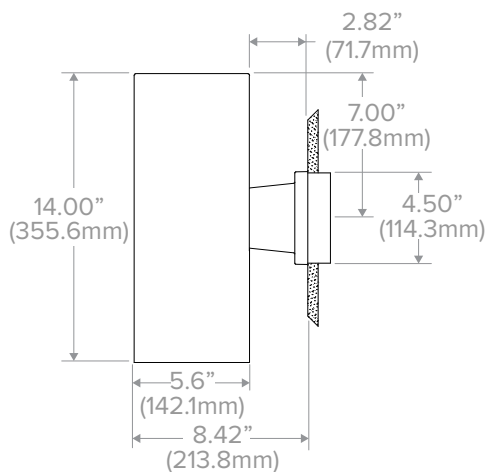

Integral Driver
Wall (-W)

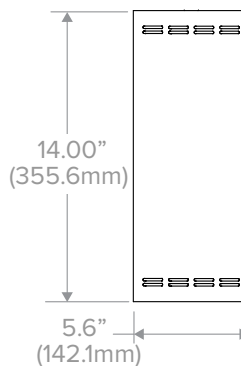

Vented Detail View
All 35L and 40L
(All Mountings)



LTC-4SQD

LITEISTRY 4" SQUARE CYLINDER

DATE:	LOCATION:
TYPE:	PROJECT:
CATALOG #:	

PHOTOMETRY

LTC-4SQD-P-20L35K8NR-DM1-S-BL

LUMINAIRE DATA

Test No.	R19.00949-01
Description	2000 lm, Narrow, 3500K, 80 CRI
Delivered Lumens	2237
Watts	22.7W
Efficacy	98.7
Mounting	Pendant
Spacing Criterion	0.6
Beam Angle (FWHM)	37

ZONAL LUMEN SUMMARY

Zone	Lumens	% Luminaire
0-40	2103	94.0
0-60	2227	99.6
0-90	2237	100.0
0-180	2237	100.0

POLAR GRAPH

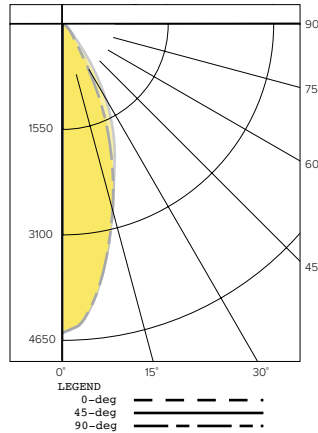

CANDELA DISTRIBUTION

Degree	Candela - 0	Candela - 45	Candela - 90
0	4527	4527	4527
5	4233	4235	4231
15	2801	2791	2788
25	1321	1711	1318
35	282	655	283
45	110	133	110
55	23	30	24
65	5	6	5
75	2	2	2
85	1	1	1
90	0	0	0

LTC-4SQD-P-20L35K8MD-DM1-S-BL

LUMINAIRE DATA

Test No.	R19.00950-01
Description	2000 lm, Medium, 3500K, 80 CRI
Delivered Lumens	2209
Watts	22.7W
Efficacy	97.4
Mounting	Pendant
Spacing Criterion	0.8
Beam Angle (FWHM)	46

ZONAL LUMEN SUMMARY

Zone	Lumens	% Luminaire
0-40	2056	93.1
0-60	2199	99.6
0-90	2209	100.0
0-180	2209	100.0

POLAR GRAPH

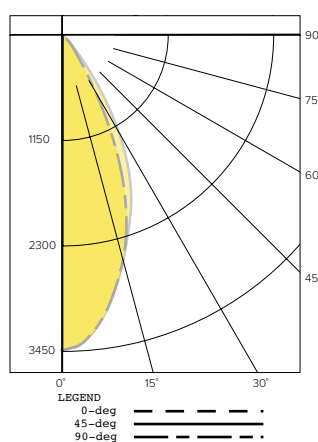

CANDELA DISTRIBUTION

Degree	Candela - 0	Candela - 45	Candela - 90
0	3435	3435	3435
5	3305	3309	3307
15	2550	2565	2556
25	1414	1761	1424
35	365	739	371
45	123	155	124
55	26	34	26
65	6	6	5
75	2	3	2
85	1	1	1
90	0	0	0

LTC-4SQD-P-20L35K8WD-DM1-S-BL

LUMINAIRE DATA

Test No.	R19.01045-01
Description	2000 lm, Wide, 3500K, 80 CRI
Delivered Lumens	2081
Watts	22.7W
Efficacy	91.8
Mounting	Pendant
Spacing Criterion	1.0
Beam Angle (FWHM)	60

ZONAL LUMEN SUMMARY

Zone	Lumens	% Luminaire
0-40	1846	96.3
0-60	2068	99.8
0-90	2081	100.0
0-180	2081	100.0

POLAR GRAPH

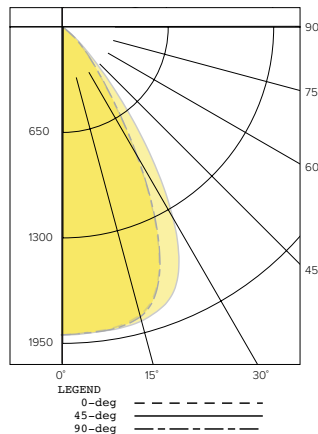

CANDELA DISTRIBUTION

Degree	Candela - 0	Candela - 45	Candela - 90
0	1906	1906	1906
5	1897	1902	1900
15	1850	1887	1861
25	1392	1702	1403
35	549	939	558
45	190	257	192
55	38	52	39
65	7	8	7
75	3	3	3
85	1	1	1
90	0	0	0

PHOTOMETRY (CONTINUED)

LTC-4SQD-P-20L35K8XW-DM1-S-BL

LUMINAIRE DATA

Test No.	R19.00952-01
Description	2000 lm, Extra Wide, 3500K, 80 CRI
Delivered Lumens	2026
Watts	22.7W
Efficacy	89.2
Mounting	Pendant
Spacing Criterion	1.2
Beam Angle (FWHM)	69

ZONAL LUMEN SUMMARY

Zone	Lumens	% Luminaire
0-40	1699	83.9
0-60	2012	99.3
0-90	2026	100.0
0-180	2026	100.0

LUMEN MULTIPLIER

Option	27K8	30K8	35K8	40K8	50K8	27K9	30K9	35K9	40K9
Multiplier	0.94	0.98	1.00	1.01	1.02	0.81	0.84	0.85	0.85

Photometrics are published below at a nominal 3500 Kelvin, 80+ CRI. This table may be used to approximate the lumen values at different Kelvin temperatures. Power consumption would stay the same.

POLAR GRAPH

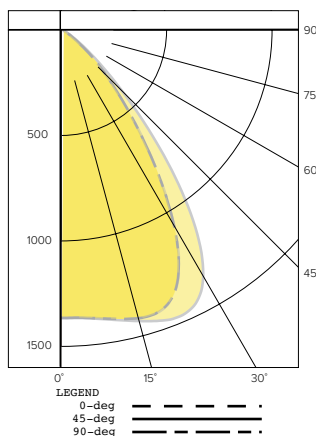

CANDELA DISTRIBUTION

Degree	Candela - 0	Candela - 45	Candela - 90
0	1368	1368	1368
5	1373	1375	1373
15	1418	1432	1417
25	1304	1458	1301
35	741	1064	738
45	271	376	271
55	48	73	49
65	8	9	8
75	3	3	3
85	1	1	1
90	0	0	0

TM-30 DATA

COLOR VECTOR GRAPHIC 3500K, 90 CRI

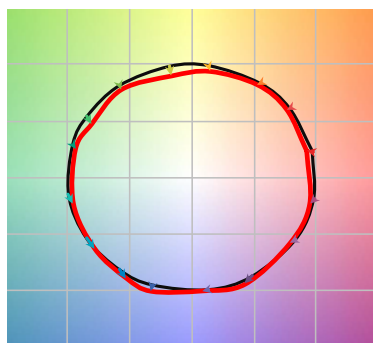

— Reference Illuminant — Test Source

COLOR DISTORTION GRAPHIC 3500K, 90 CRI

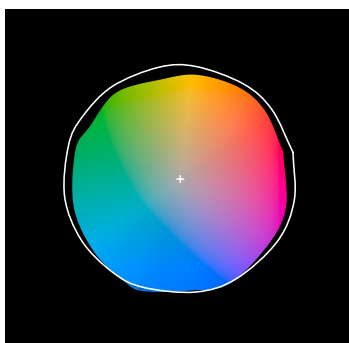

TEST RESULTS - 3500K		
Value	80+ CRI	90+ CRI
R _i	84	88
R _g	95	95
CCT (K)	3411	3419
D _{uv}	0.0015	0.0042
x	0.4120	0.4147
y	0.3974	0.4052
CIE R _a	84	93
CIE R _g	11	62

COLOR VECTOR GRAPHIC 3500K, 80 CRI

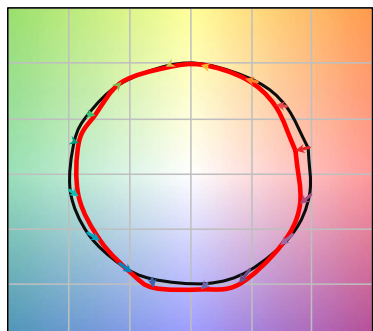

— Reference Illuminant — Test Source

COLOR DISTORTION GRAPHIC 3500K, 80 CRI

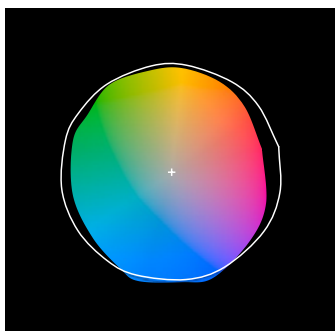



LTC-4SQD

LITEISTRY 4" SQUARE CYLINDER

DATE:	LOCATION:
TYPE:	PROJECT:
CATALOG #:	

ELECTRICAL DATA

DRIVER DATA		
Input Voltage	120-277 V	347 V
Input Frequency	50/60 Hz	50/60 Hz
Power Factor	≥0.90	≥0.90
THD	<20%	<20%
EMI Filtering (FCC 47 CFR Part 15)	Class A	Class A
Operating Temperature	-20° C to 40° C	-20° C to 40° C

* Values for DM1 option shown, values for other dimming options may vary.

WATTAGE DATA		
Lumen Output	Nominal Lumens	WATTAGE
06L	600	8
10L	1000	12
15L	1500	19
20L	2000	23
25L	2500	28
30L	3000	35
35L	3500	43
40L	4000	52

* Wattage may vary based on configuration and options selected

ADDITIONAL INFORMATION

DIMMING COMPATIBILITY CHART		
Dimming Driver	Manufacturer	Web Link
DM1/DM01	Lutron DDTV	http://bit.ly/11jSvZg
DM1	Leviton AWRMG-7xx, AWSMG-7xx, AWSMT-7xx	http://bit.ly/1BjN2R9
EDM	Lutron	http://bit.ly/1vtjHAI
2DM	Lutron	http://bit.ly/1S4WjXK

DMX

See instruction sheet on www.prescolite.com for connection & installation information.

ENERGY STAR® Certified Models

For a list of certified models, click on the ENERGY STAR® MODELS link or visit www.energystar.gov.