

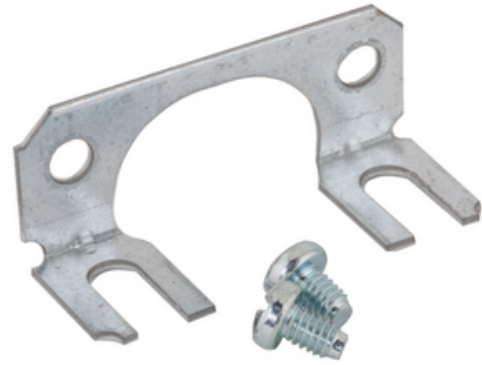

Replacement Plaster Ears - Open Style with Screws

By Raco
Catalog # 961



Replacement Plaster Ears, Open Style with Screws

Features

- Replacement ears to mount on Raco boxes 410, 420, 440, 445, 500, 503, 506, 508, 526, 545, 560, 565, 567, 570RAC, 590, 600 and 601
- Use for old-work application
- Mounting screws provided
- Use with 1/2 in. thick standard drywall

General

Accessory Type	Box
EU RoHS Indicator	Contact Manufacturer
Type	Plaster Ears
UPC	050169009611

Dimensions

Dimensions	0.609 in x 0.594 in x 1.5 in
Height	1.5 in
Length	0.609 in
Weight	0.02 lb
Width	0.594 in

Certifications And Compliance

Certified Listed	UL Listed
------------------	-----------

Logistics

Carton Quantity	100
Minimum Pack Quantity	100
Pallet Quantity	48000

Product Assets

[Catalogs - RACO / TayMac / Bell Full Catalog](#)
[Certifications - UL COC - E195978-21](#)
[SDS - HCC SDS](#)
[Terms and Conditions - HCC Terms & Conditions](#)



A Hubbell brand