



Catalog # 4040RACCN

DOUBLE BARREL PUSH-IN CABLE CONNECTORS

3/8 IN. ARMORED CABLE CONNECTOR, .470 - .610

FEATURES

- Rugged one-piece design provides fast tool-free install
- Fits standard 1/2" knockouts in electrical boxes or enclosures
- Both connectors designed to terminate MC, MCI-A, AC, AC HCF, MCI-A HFC, MC-PCS AND RWFC
- Tinted gold inside to indicate larger cable range
- Die-cast zinc construction with nylon anti-short bushing

APPLICATIONS

RACO's new Double Barrel Push-in cable connectors make it easy to secure metal-clad cable into boxes or enclosures. Simply insert a cable into the cable opening, then snap the box end of the connector into a box knockout, done! No tools needed for a secure assembly. Push-in connectors are perfect for new or old work and can be removed and reused.

CERTIFICATIONS



GENERAL PRODUCT INFORMATION

TRADE TWO 3/8

DRAWING DIMENSIONS

DIMENSION	2.06
DIMENSION	0.63
DIMENSION	0.59

PACKAGING

PACKAGE TYPE:	CARTON
UNIT CARTON QTY:	25
PRODUCT UPC-A LABELED:	805035054796
WEIGHT (LBS. PER/C):	21.77
SHIP CARTON LENGTH (IN.):	9.7
SHIP CARTON WIDTH (IN.):	9.2
SHIP CARTON HEIGHT (IN.):	7.9
CTN WEIGHT (LBS.):	21.77
UNIT CARTON 12OF5:	30805035054797
SHIP CARTON 12OF5:	50805035054791

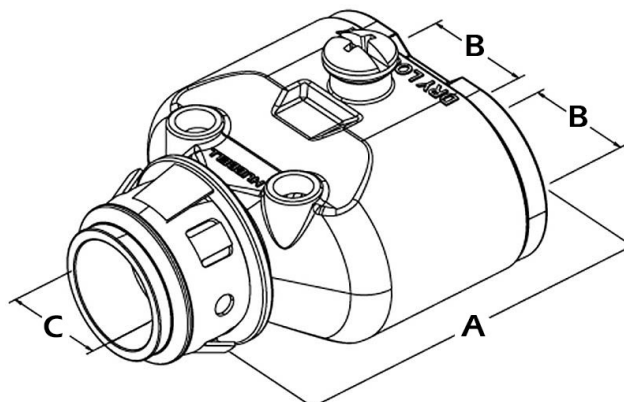

HUBBELL CANADA
870 Brock Road South Pickering, ON L1W 1Z8
1-800-465-705 www.hubbell.ca

© 2021 Hubbell. All rights reserved. Information subject to change. Trademarks are property of their respective owners.



RA_4040Spec_CANEN 11/22