



# LB4 & LBEB4

LED Downlight Module

9W High Efficacy  
Wet Location  
120V

### APPLICATIONS:

LiteBox LED modules are designed for use in new construction as well as retrofit applications with existing Prescolite or competitive 4" housings using the included screw base adapter. Lumen output and distribution comparable to a 65W BR30 while consuming only 9 watts. ENERGY STAR® qualified. Can be used to comply with California Title 24 Commercial and IECC watts per square foot requirements. Suitable for use with continuous room side ambient temperature up to 25°C. Continuous dimming to 10% with most standard dimmers. (See Dimming Notes).

### LIGHT ENGINE:

High efficacy LED light engine, available in 2700K, 3000K, 3500K and 4000K. 120VAC, 50/60Hz, with output over-voltage, over-current, and short circuit protection. System designed for optimal life and lumen maintenance (60,000 hours at 70% lumen maintenance per TM-21).

### LENS/REFLECTOR:

All LiteBox LED modules are provided standard with a diffused optical grade, impact resistant polycarbonate lens for uniform illumination and superior glare control. Reflector powder coat finish creates aesthetic ceiling appearance and visually comfortable cutoff.

### INSTALLATION:

For New Construction: Use with Prescolite IBX QuickLink LED housings. QuickLink connector mates directly to housing connector without a screw base adapter for compliance to California Title 24 non-screw base socket requirement.

For Retrofit: Use in Prescolite or other compatible 4" recessed housings using supplied screw base adapter.

Easy installation with (3) stainless steel spring clips (pre-installed).

### CERTIFICATIONS:

CSA Classified for use in Prescolite or other 4" recessed housings including Halo, Juno, and Lithonia. (See page 3 for more details) Suitable for wet locations. ENERGY STAR qualified. Can be used to meet California Title 24 commercial with IBXQL.

### WARRANTY:

5 year warranty

Additional information on pg 3.

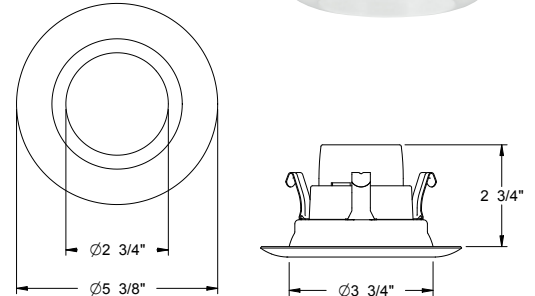

LB4A

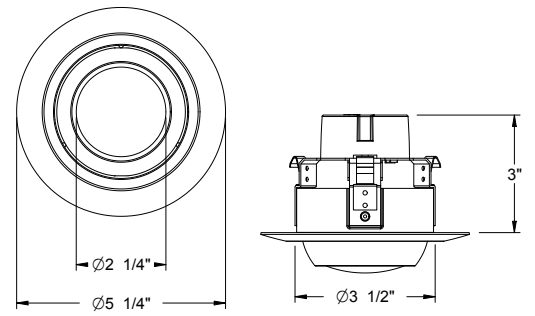

LBEB4A

CATALOG NUMBER:

EXAMPLE: LB4A6L30K9 WH

TRIM	OUTPUT	CCT	CRI	TRIM COLOR	ACCESSORIES
<input type="checkbox"/> <b>LB4A</b> 4" LiteBox Downlight LED Module with dimming to 10% 120V	<input type="checkbox"/> <b>6L</b> 600 Lumens	<input type="checkbox"/> <b>27K</b> 2700 Kelvin <input type="checkbox"/> <b>30K</b> 3000 Kelvin <input type="checkbox"/> <b>35K</b> 3500 Kelvin <input type="checkbox"/> <b>40K<sup>2</sup></b> 4000 Kelvin	<input type="checkbox"/> <b>9</b> 90+ CRI	<input type="checkbox"/> <b>WH</b> White	<input type="checkbox"/> <b>LiteGear<sup>1</sup></b> Inverter, single phase central lighting, 125VA-250VA <input type="checkbox"/> <b>LPS Series<sup>1</sup></b> LitePower micro-inverter, 20VA-55VA <input type="checkbox"/> <b>IBX4QL-120</b> IC/Non-IC Airtight housing with supply wire quick connects

#### NOTES

- <sup>1</sup> See Central Inverter compatibility note and web links on page 3
- <sup>2</sup> Not available with LBEB4
- <sup>3</sup> Damp location only

Web: [www.securitylighting.com](http://www.securitylighting.com)

2100 Golf Road, Suite 460, Rolling Meadows, IL 60008-4704

Phone: 1-800-LIGHT IT, 1-800-544-4848, Fax: 847-279-0642

Copyright ©2016 Security Lighting, a division of Hubbell Lighting, Inc.

All Rights Reserved. • Specifications subject to change without notice. • Printed in U.S.A. • 01/19





prescolite  
**LB4 & LBEB4**  
 LED Downlight Module

9W High Efficacy  
 Wet Location  
 120V

# PHOTOMETRIC DATA

## ELECTRICAL DATA 4"

Input Voltage	120V AC
Input Frequency	50/60 Hz
Input Current	0.08A
Input Power	9.0W
Power Factor	>0.90
THD	<20%
EMI Filtering	FCC 47CFR Part 15, Class B
Operating Temperature	-30°C to 25°C
Dimming	Yes*

Over-voltage, over-current, short-circuit protected  
 \*See Dimming Notes for more information

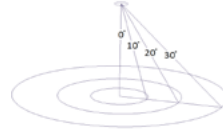

## INITIAL FOOTCANDLES (fc) DATA CHART

LB4A6L30K9 WH											
Single Unit, fc on 30" Work Plane						Ceiling to Floor Height (feet)	Multiple Units, Average fc on 30" Work Plane				
0° (nadir)	10°		20°		30°		Fixture Spacing (feet)	RCR 2	RCR 5	RCR 7	
fc	fc	Illuminated Diameter (feet)	fc	Illuminated Diameter (feet)	fc			Illuminated Diameter (feet)	footcandles (fc)		
10	10	2	8	4	5	6	8	6 x 6	16	12	10
7	7	2	5	5	4	8	9	7 x 7	12	8	7
5	5	3	4	6	2	9	10.5	9 x 9	8	6	5
4	4	3	3	6	2	10	11	9 x 9	7	5	4

\*Spacing to Mounting Height ratio 1.1

### LB4A6L30K9 WH

LED Light Engine: 3000K 90 CRI  
 System Wattage: 9.0W  
 Fixture delivered lumens: 622  
 Fixture Efficacy: 69.3  
 Spacing Criteria: 1.1

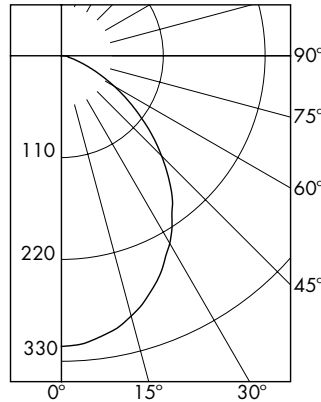

Test No. 17.00240

Tested at 25°C Ambient in accordance to IESNA LM-79-2008

CANDELA DISTRIBUTION	
DEG	CANDELA
0	314
5	311
15	291
25	256
35	208
45	153
55	93
65	42
75	13
85	5
90	0

## COEFFICIENTS OF UTILIZATION

### Zonal Cavity Method

Room Cavity Ratio	% Effective Ceiling Cavity Reflectance									
	80%		70%		50%		30%			
	70	50	30	10	70	50	30	10		
1	111	107	103	100	108	98	100	98	97	94
3	94	85	78	73	92	72	81	75	78	74
5	81	69	61	56	79	55	66	60	64	59
7	70	58	50	44	68	44	55	49	54	48
9	61	49	41	36	60	36	47	41	46	40

LB4A6L30K9 WH

Test No. 17.00240

### ZONAL LUMEN SUMMARY

ZONE	LUMENS	%LUMINAIRE
0-30	229	36.8
0-40	359	57.8
0-60	561	90.1
0-90	622	100.0

### LBEB4A6L30K9 WH

LED Light Engine: 3000K 90 CRI  
 System Wattage: 8.6W  
 Fixture delivered lumens: 637  
 Fixture Efficacy: 73.8  
 Spacing Criteria: 1.1

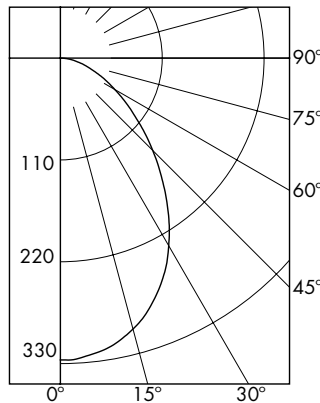

Test No. 17.00242

Tested at 25°C Ambient in accordance to IESNA LM-79-2008

CANDELA DISTRIBUTION	
DEG	CANDELA
0	326
5	323
15	303
25	262
35	203
45	141
55	89
65	51
75	25
85	7
90	2

## COEFFICIENTS OF UTILIZATION

### Zonal Cavity Method

Room Cavity Ratio	% Effective Ceiling Cavity Reflectance									
	80%		70%		50%		30%			
	70	50	30	10	70	50	30	10		
1	110	106	102	99	108	97	100	97	96	93
3	94	84	77	71	91	71	80	74	77	72
5	80	69	60	54	78	54	65	59	64	58
7	70	57	49	43	68	43	55	48	53	47
9	61	49	41	36	60	36	47	40	46	40

LBEB4A6L30K9 WH

Test No. 17.00242

### ZONAL LUMEN SUMMARY

ZONE	LUMENS	%LUMINAIRE
0-30	236	37.0
0-40	363	56.9
0-60	551	86.5
0-90	637	99.9



prescolite

# LB4 & LBEB4

LED Downlight Module  
9W High Efficacy  
Wet Location  
120V

**Central Inverters**

For full fixture output in back-up mode, we recommend you visit [www.dual-lite.com](http://www.dual-lite.com) for your Central Lighting Inverter options. Please contact your local Hubbell representative for any assistance with proper sizing and loading of your inverter selection. Central lighting inverters must be ordered separately.

**LiteGear:** [www.dual-lite.com/products/litegear\\_lg\\_series](http://www.dual-lite.com/products/litegear_lg_series)

**LPS Series:** [www.dual-lite.com/products/lps](http://www.dual-lite.com/products/lps)

**DIMMING NOTES:**

Prescolite's recessed LED modules are designed to be compatible with many dimmer controls. Electronic low-voltage rated dimmer controls may offer favorable dimming performance. Incandescent type dimmers are not recommended. The following is a list of known compatible dimmer controls:

Manufacturer	Series	Part Number	Dimmer Type
Lutron	Nova T	NTELV-300	ELV
Lutron	Spacer	SPSELV-600	ELV
Lutron	Maestro	MAELV-600	ELV
Lutron	Diva	DVELV-300P	ELV
Leviton	Decora SureSlide	6672-1LW	LED, CFL
Leviton	SureSlide	6615-P	ELV
Leviton	Renoir	AWRMG-EAW	ELV
Pass & Seymour	Harmony	DCL453PTCCCV6	LED, CFL

Incandescent Digital type dimmers are not recommended.

Dimming capabilities will vary depending on the dimmer control, load, and circuit installation. Always refer to dimmer manufacturer instructions or a controls specialist for specific requirements.

Dimmer control brand names where identified above are tradenames or registered trademarks of each respective company.

**COMPATIBILITY OF 4" RECESSED HOUSINGS:**

LiteBox LED modules are ETL classified for use with Prescolite and most competitive recessed cans (with "A" and "B" dimensions)

**Prescolite**

- Capri
- Commercial Electric
- Elco
- Emerald
- Halo
- Intense
- Jimway

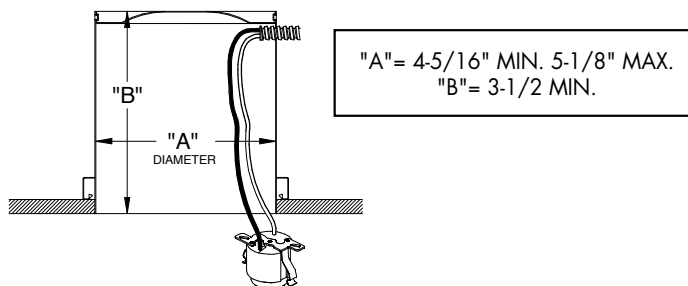

**NOTES**

1. Operation in ambient temperatures higher than those specified will shorten life and void warranty.
2. Warranty is limited to repair and replacement of defective parts of the LED system and does not include labor or installation. See [www.prescolite.com](http://www.prescolite.com) for details.

