

H-MOSS® Controls

Adaptive Passive Infrared Wall Switches

Wall Switches

Features

- Manual ON (Vacancy)
- Built in photocell with manual super saver mode for daylight harvesting
- Designed for use on 120 or 277V AC circuits. No neutral needed for fast retrofits

Ordering Information

Description	Device Color	UPC Number	Catalog Number
Passive infrared, Single Circuit, 1 button for manual control	Light Almond	783585414454	AP2001LA1

Listings

cULus Listed
Meets ASHRAE 90.1
CEC Title 24 Certified

Specifications

Housing	High impact plastic (UL-94-5V)
Mounting Strap	Plated steel
Lens	Dual element pyrometer and 12 element cylindrical hard lens
Sensing Indicator	Passive Infrared, Red LED

Performance

Electrical	
Load Capacity	Incandescent - 0 to 800 watts, 120V AC Ballast - 0 to 1000 watts, 277V AC Ballast 0 to 1800 watts
Power Supply	120/277V AC, 50/60Hz

Mechanical	
Wire Leads	#18 AWG stranded wire, 6" long with ½" stripped ends

Environmental	
Operating Temperature	32° F to 104°F (0°C to 40°C); 0% to 95% non-condensing relative humidity

Controls	
Ambient Light	Adjustable ambient light override, 10 to 500 foot candles
Front Press Switch	Manual ON operating mode
Sensitivity	Adaptive 0% to 100%
Time Delay	Digital, adaptive 4 to 30 minutes, 20 minutes default

Coverage Pattern	
Area	1000 square foot. Area of coverage based on minor motion pattern. See illustration.
Mounting Height	42 to 54 inches above floor

HUBBELL

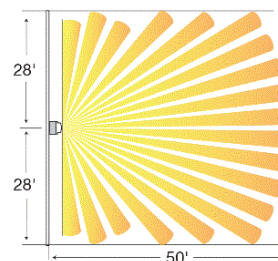
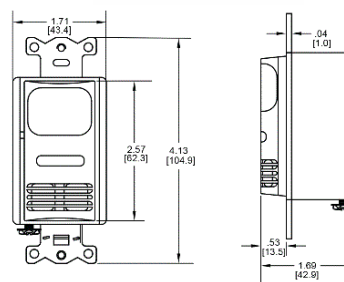

Accessories

Wallplate	NP26LA, SS26
-----------	--------------

Online Resources

Customer Use Drawing
eCatalog
Installation Instructions

Dimensions in Inches (mm)

Hubbell Wiring Device-Kellems • Hubbell Incorporated (Delaware) • 40 Waterview Drive • Shelton, CT 06484

Phone (800) 288-6000 • Fax (800) 255-1031 • Specifications subject to change without notice.

