

**inSIGHT**  
**Circuit-Lock Disconnect**  
**with LED Indicators**

**Features**

- Six highly visible integral phase identification LEDs for use on 3 Phase Y system
- Secondary confirmation of isolation of power
- Certified by NSF
- Highly visible red handle meets OSHA LO/TO capabilities
- Accepts up to 2 Auxiliary contacts

**Ordering Information**

| Description                          | UPC Number   | Catalog number |
|--------------------------------------|--------------|----------------|
| SS Disconnect, 60, LED, 4X Rep Cover | 783585640396 | HBLDS6SSRCP    |

**Listings**

cULus Listed  
 NSF

**Specifications**

|                         |                               |
|-------------------------|-------------------------------|
| Environmental rating    | UL Witnessed IP69K, 4X and 12 |
| Enclosure: Base and Top | PBT                           |
| Handle                  | PBT                           |
| Conduit Hub             | 1 1/4" Zinc                   |
| Enclosure Gasket        | Neoprene                      |
| Frame                   | Galvanized Steel              |
| Enclosure Screws        | Stainless Steel 300 Series    |
| Shaft (Unfused)         | PBT                           |
| Shaft Seal              | Molded Neopren                |
| LED Lense               | PC                            |

**Performance**

| Electrical   |  |
|--|--|
| Current Interrupting                                     | Certified for current interrupting at full rated current and voltage<br>Withstands 3000V AC minimum  |
| Dielectric Voltage                                       | 600V AC RMS  |
| Max. Working Voltage                                     | (SCCR): (Motor Disconnect) Suitable for use on a circuit capable of delivering not more than 65kA RMS symmetrical, 600V AC max. when protected by Class J fuses rated 30A max. |
| Short Circuit Current Ratings (SCCR): (Motor Disconnect) |  |

| Mechanical              |  |
|-------------------------|--|
| Impact Resistance       | In accordance with UL 746C                               |
| Mounting                | External fully adjustable feet                           |
| Terminal Identification | In accordance with UL, CSA and international conventions |

| Environmental         |   |
|-----------------------|---|
| Flammability          | UL94-5VA and V0 Classification  |
| Moisture Resistance   | Indoor and Outdoor – Type 4X (Wash down, Corrosion resistant); Indoor – Type 12 (Dust-tight, Falling Dirt, Noncorrosive Liquids). |
| Operating Temperature | Max. Continuous: 75°C; Min. Continuous: -40°C without impact  |

**HUBBELL**

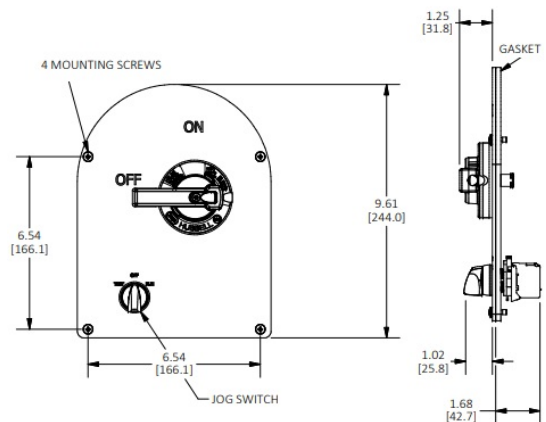

**Complementary Products**

|   |          |
|---|----------|
| "Break After Main" 1NO & 1 NC Aux Contact | HBLAC1   |
| "Break Before Main" 1NO Aux Contact       | HBLAC2   |
| 1 1/4" Stainless Steel Conduit Hub        | HUB125SS |

**Online Resources**

Customer Use Drawing  
 eCatalog  
 Installation Instructions

Dimensions in Inches (mm)

Hubbell Wiring Device-Kellems • Hubbell Incorporated (Delaware) • 40 Waterview Drive • Shelton, CT 06484

Phone (800) 288-6000 • Fax (800) 255-1031 • Specifications subject to change without notice.

