

netSELECT

Wallplates

Molded-In Video and C5e Data Frame

Features

- High Impact-Resistant Thermoplastic Construction
- Aesthetically Pleasing, Molded-In Appearance

Ordering Information

Description	Color	UPC Number	CatalogNumber
Molded-In Video and Voice Decorator Frame, One Cat 5e 110 Punch-Down, One F-Type Coupler Bulkhead, Female to Female, Screw Termination	Black	883778501999	NS785BK

Listings

Meets FCC part 68
UL Listed
CSA Certified
RoHS Compliant

Specifications

Material	High-Impact Resistant Thermoplastic
Phone Termination Style	Screw
Category 5e Termination Style	Punch Down

Complementary Products

Wallplate	NP26BK
-----------	--------

Online Resources

Customer Use Drawing
eCatalog

HUBBELL

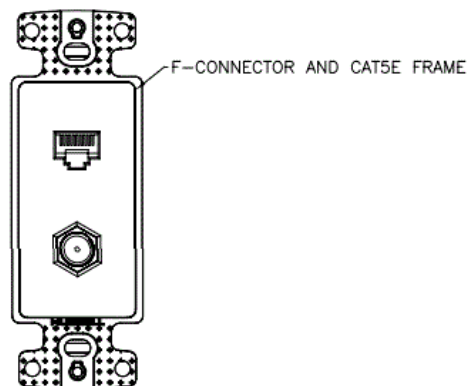
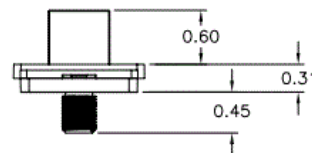

Dimensions in Inches (mm)

Hubbell Wiring Device-Kellems • Hubbell Incorporated (Delaware) • 40 Waterview Drive • Shelton, CT 06484

Phone (800) 288-6000 • Fax (800) 255-1031 • Specifications subject to change without notice.

