

**Floor Boxes**  
**Flush Round Single or Multi-Service**  
**Non-Metallic Concrete Floor Box**

# HUBBELL

**Features**

- Concrete cover, conduit reducers and conduit hub plugs included
- Economical, easy to install, in-floor delivery system for open plan spaces
- Universal Cover mounts eliminate the need of additional adapter collar

**Ordering Information**

Description	Device Color	UPC	Catalog Number
Non-Metallic, Concrete	Gray	783585342757	PFB1



**Listings**

UL File Number E92074  
 CSA File Number LR18416

**Specifications**

Material	PVC
Min. Depth of Pour	3.00" (76.2)
Hubs	1.0" and 3/4" conduit hubs
Capacity	100 cubic inches prior to cutting level to floor

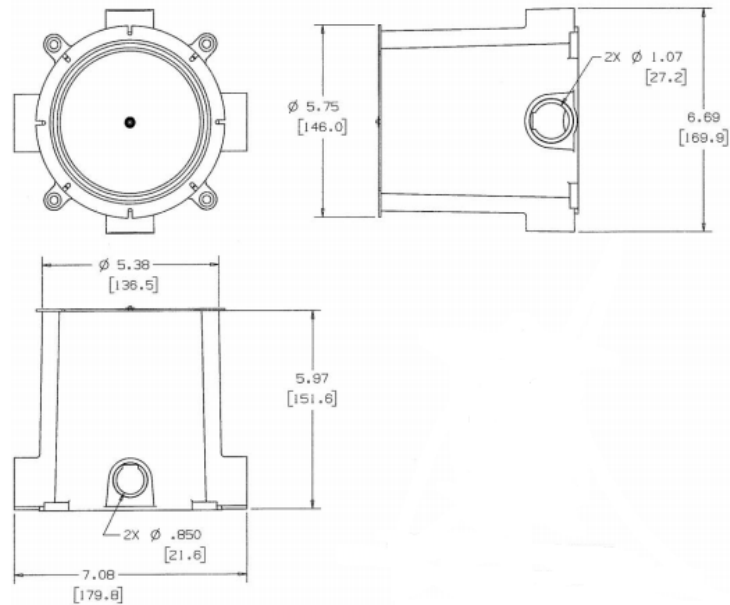

**Online Resources**

[Customer Use Drawing](#)  
[eCatalog](#)  
[Installation Instructions](#)

Dimensions in Inches (mm)

Hubbell Wiring Device-Kellems • Hubbell Incorporated (Delaware) • 40 Waterview Drive • Shelton, CT 06484

Phone (800) 288-6000 • Fax (800) 255-1031 • Specifications subject to change without notice.

