

3P – Contemporary Tri-Post Pole

TYPE



3P

1. POLE	2. OAH	3. COLOR	5. OPTIONS/ACCESSORIES	

1. POLE	2. OAH	WT	MAXIMUM ALLOWABLE EPA (MPH)								
			85	90	100	110	120	130	140	150	
3P8	8' (2.5m)	-	46	28.8	25.5	20.3	16.5	13.6	11.4	9.6	8.1
3P10	10' (3.1m)	-	51	22.3	19.7	15.5	12.4	10.1	8.3	6.8	5.7
3P12	12' (3.7m)	-	57	17.8	15.6	12.1	9.5	7.5	6.0	4.8	3.8
3P14	14' (4.3m)	-	63	14.1	12.2	9.3	7.1	5.5	4.2	3.1	2.3
3P16	16' (4.9m)	-	68	10.6	9.0	6.6	4.8	3.4	2.4	1.5	0.85
3P18	18' (5.5m)	-	73	7.4	6.1	4.1	2.7	1.5	0.70	0.03	-
3P20	20' (6.2m)	-	78	4.5	3.5	1.9	0.75	-	-	-	-

Note: Overall height is measured to post top adapter, or top of pole cap.

2. COLOR

BLS	Black Gloss Smooth
BLT	Black Matte Textured
DBS	Dark Bronze Gloss Smooth
DBT	Dark Bronze Matte Textured
GTT	Graphite Matte Textured
LGS	Light Grey Gloss Smooth
LGT	Light Grey Matte Textured
PSS	Platinum Silver Smooth
VGT	Verde Green Textured
WHS	White Gloss Smooth
WHT	White Matte Textured

Color Option

CC* Custom Color

* Consult factory for custom color, marine and corrosive finish options

4. OPTIONS / ACCESSORIES

RBC (Cast aluminum receptacle housing, integrally welded to the pole. Includes a NEC approved clear weather proof cover. Does not include a receptacle or internal wiring.)

TA (Tenon adaptor for SP2)

SPECIFICATIONS

Base shall be cast aluminum #356 alloy, free of any porosity, foreign materials, or cosmetic fillers. Base casting shall be heat treated to a T-6 condition, and of uniform wall thickness, with no warping or mold shifting.

WARNINGS

Caution must be exercised in the selection of a design wind speed when the pole is to be installed in a special wind region (as indicated by the wind map) or in an area where wind speed is unpredictable.

AAL recommends consulting a local engineer when the pole is to be installed in an area that may be subject to extreme weather and exposure

Poles installed on structures such as buildings and bridges may be subjected to vibration, oscillations, and other fatigue effects which are not covered by the AAL warranty.

The use of banners or other appendages can severely affect the loading of a pole. No banner or other appendage should be attached to an AAL pole unless approved by AAL.

If the products are to be used on an existing foundation or on other structures, the customer assumes all responsibility for the structural integrity of the existing foundation, anchorage or structures and all the consequences arising therefrom.

CAUTION

Poles should never be erected without the luminaire installed.

Anchor bolts are 3/4" x 24" x 3" hot dip galvanized steel. Six galvanized hex nuts and flat washers, and a bolt circle template are provided.

CERTIFICATION

Certified UL 1598 in accordance with Article 410 of ANSI/NFPA 70, National Electrical Code.

JOB _____
TYPE _____
NOTES _____



ARCHITECTURAL AREA LIGHTING
17760 Rowland Street | City of Industry | CA 91748
P 626.968.5666 | F 626.369.2695 | www.aal.net
Copyright © 2016 November 9, 2020 7:00 PM

DIMENSIONS

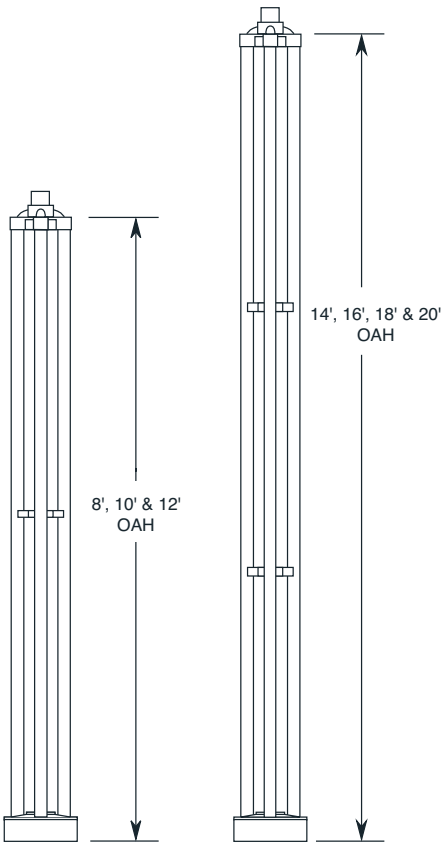

BOLT CIRCLE: 8.25"
3 BOLTS

BOLT PROJECTION:
3 3/4"

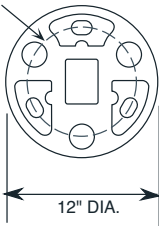

(INDICATES POLE IS LAYING DOWN
WITH HANDHOLE FACING UP)