

SLA20B/SLA20B-2 – Contemporary Arms

TYPE

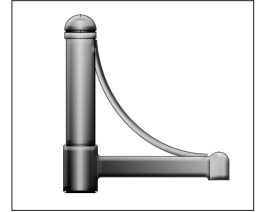

SLA20B

1. ARM

2. COLOR

1. ARM

SLA20B (Slips over 4" pole. Weight: 14 lbs. EPA: 1.40)

SLA20B-2 (Twin arms, slips over 4" pole. Weight: 24 lbs.

EPA: 1.70)

2. COLOR

BLS	Black Gloss Smooth
BLT	Black Matte Textured
DBS	Dark Bronze Gloss Smooth
DBT	Dark Bronze Matte Textured
GTT	Graphite Matte Textured
LGS	Light Grey Gloss Smooth
LGT	Light Grey Matte Textured
PSS	Platinum Silver Smooth
VGT	Verde Green Textured
WHS	White Gloss Smooth
WHT	White Matte Textured

Color Option

CC* Custom Color

* Consult factory for custom color, marine and corrosive finish options

DIMENSIONS

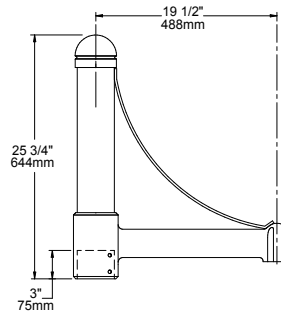

SLA20B (4" pole)

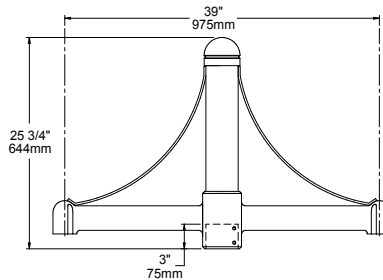

SLA20B-2 (4" pole)

SPECIFICATIONS

The arm shall be of one piece unitized aluminum construction, fully welded and assembled. The slip fitter shall be cast aluminum with an internal wireway and pole stop. The arm shall be prewired with a quick connector for easy installation.

The arm shall have a cast aluminum fitter welded to the top of the arm(s) for attaching the fixture. The fixture shall be mounted with three stainless steel bolts through the top of the arm fitter into the fixture. The attachment point shall have a silicone pad for sealing the fixture to arm connection.

The arm shall slip over a 4"/100mm or 5"/125mm diameter pole or tenon. The cast aluminum slip fitter shall have six stainless steel cup point set screws for securing the arm to the pole or tenon.

JOB _____
 TYPE _____
 NOTES _____



ARCHITECTURAL AREA LIGHTING
 17760 Rowland Street | City of Industry | CA 91748
 P 626.968.5666 | F 626.369.2695 | www.aal.net
 Copyright © 2016 November 9, 2020 7:29 PM