

WMA18 – Contemporary Wall Mount Arm

TYPE

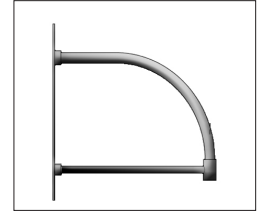

WMA18

1. ARM

2. COLOR

1. ARM

WMA18 (Weight: 18 lbs.)

2. COLOR

BLS	Black Gloss Smooth
BLT	Black Matte Textured
DBS	Dark Bronze Gloss Smooth
DBT	Dark Bronze Matte Textured
GTT	Graphite Matte Textured
LGS	Light Grey Gloss Smooth
LGT	Light Grey Matte Textured
PSS	Platinum Silver Smooth
VGT	Verde Green Textured
WHS	White Gloss Smooth
WHT	White Matte Textured

Color Option

CC* Custom Color

** Consult factory for custom color, marine and corrosive finish options*

DIMENSIONS

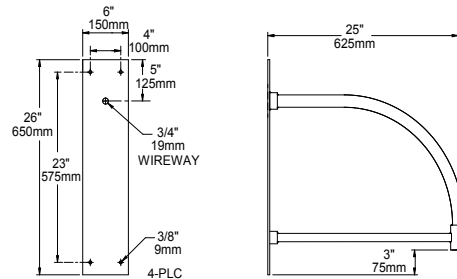

Note: Back plate is welded to the arm.

WMA18

SPECIFICATIONS

The arm shall be of one piece unitized aluminum construction, fully welded and assembled. The back plate shall be one piece cast aluminum. The arm shall be prewired with a quick connector for easy installation.

The arm shall have a cast aluminum fitter welded to the top of the arm(s) for attaching the fixture. The fixture shall be mounted with three stainless steel bolts through the top of the arm fitter into the fixture. The attachment point shall have a silicone pad for sealing the fixture to arm connection.

Mounting hardware and J-box by others.

JOB _____
TYPE _____
NOTES _____



ARCHITECTURAL AREA LIGHTING
17760 Rowland Street | City of Industry | CA 91748
P 626.968.5666 | F 626.369.2695 | www.aal.net
Copyright © 2016 November 9, 2020 7:09 PM