

6" Horizontal Triple Open & Wall Wash Downlight

CFT632HEB

One 26W, 32W, or 42W Triple Tube 4-Pin Lamp
Non-IC Rated
120V, 208V, 240V, 277V, or 347V

DATE: _____ TYPE: _____
 FIRM NAME: _____
 PROJECT: _____



Ceiling Cutout: 6 1/4"

Maximum Ceiling Thickness: 1 1/4"

For conversion to millimeters,

multiply inches by 25.4

Not to Scale

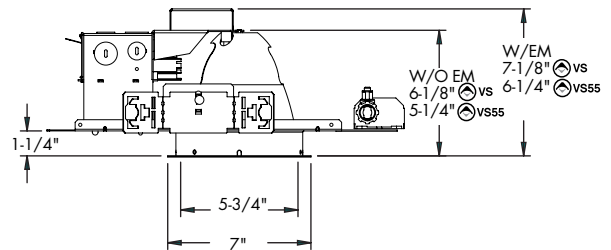
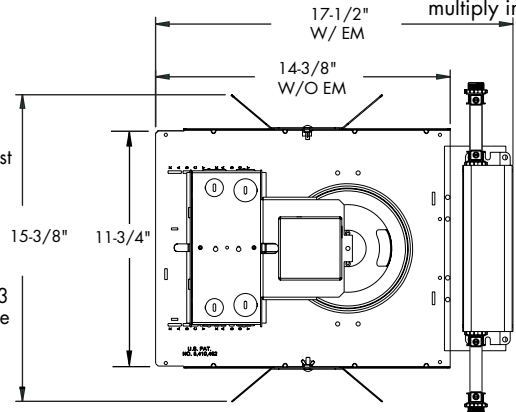

Featuring VirtualSource⁵⁵ VSSS Reflectors

Featuring VirtualSource VS Reflectors

APPLICATIONS:

The CFT632HEB offers a horizontally lamped compact fluorescent downlight and wall wash fixture that provides superior brightness and glare control. The multi-watt multi-volt ballast provides the ability to change wattages by simply replacing the lamp. This luminaire is ideal for a wide variety of low to medium height ceiling applications including commercial, retail, and hospitality. The CFT632HEB is compatible with the Signosó family of architectural elements.

HOUSING:

One-piece 18-gauge galvanized steel platform. Prewired J-box with snap-on cover for easy access. Vented at lamp tip and socket for maximum light output. Same housing accommodates downlight and wall wash downlight reflectors.

REFLECTOR:

High purity aluminum Alzak Virtual Source[®] iridescence suppressed reflector. Self-trim standard. Painted white self-trim available. Baffled units standard with painted white self-trim.

BALLAST:

One (1) compact fluorescent Class 'P' electronic multi-volt (120V through 277V) ballast suitable for operating 26W, 32W, and 42W triple tube lamps. EOL protection standard. Accessible from below ceiling. 347V available (specify wattage when ordering).

LAMP:

One (1) 26W (GX24q-3 base), 32W (GX24q-3 base), or 42W (GX24q-4 base) 4-pin triple tube compact fluorescent lamp. Lamps furnished by others or as option below.

SOCKET:

One (1) injection molded socket suitable for 26W, 32W, and 42W triple tube lamps (vented).

INSTALLATION:

Universal adjustable mounting brackets accommodate 1 1/2" or 3/4" lathing channel or 1/2" EMT (by others), or Prescolite 24" bar hangers (B24 or B6).

LABELS:

UL listed or UL/CSA listed with CDN option for damp locations. Approved for through wiring. Non-type I.C.

LAMP INCLUDED OPTION:

Specify lamp type T (Triple 4-pin) and temperature as shown below.

CATALOG NUMBER:

EXAMPLE: CFT632HEBDMEM STF602HCG LP32T30K B24

HOUSING	HOUSING OPTIONS	HOUSING OPTIONS	HOUSING OPTIONS	REFLECTOR	REFLECTOR COLOR	ACCESSORIES
<input type="checkbox"/> CFT632HEB 6" 26W 32W/42W triple tube, multi-volt electronic ballast <input type="checkbox"/> CFT632HEB55 ^{1,2} 6" 26W 32W/42W triple tube, multi-volt electronic ballast, 55 Degree Cut-off	<input type="checkbox"/> CDN Canadian electrical code compliant ballast disconnect <input type="checkbox"/> CDN 347V ¹ Canadian electrical code compliant ballast disconnect <input type="checkbox"/> CP ^{3,8} Chicago Plenum. Fixture construction and/or specifications may vary. Refer to Chicago Plenum specification sheets on www.prescolite.com for details. <input type="checkbox"/> DM Electronic Analog Dimming Ballast to 5%, 4-wire (specify voltage/wattage; 120V-277V)	<input type="checkbox"/> ECDM ¹¹ Lutron EcoSystem or 3-wire line voltage dimming ballast (120-277V). Dims to 5%. <input type="checkbox"/> HDM ^{2,3} Lutron Hi-Lume Dimming Ballast to 1%, 3-wire line voltage (specify supply voltage/wattage) <input type="checkbox"/> 2DM ^{2,3} Lutron Tu-Wire Dimming Ballast to 5%, 2-wire line voltage (120V only) <input type="checkbox"/> 7DM Advance Mark 7 Dimming Ballast to 5% <input type="checkbox"/> 4-wire, 0-10V, analog (120V-277V) (specify wattage) <input type="checkbox"/> XDM Advance Mark 10 Dimming Ballast to 5%, 2-wire, line voltage (specify voltage/wattage)	<input type="checkbox"/> EM ^{6,13,14} Emergency battery pack with integral test switch and indicator light <input type="checkbox"/> FSDFA Fuse kit installed at factory <input type="checkbox"/> RIF1 ^{13,14} Radio interference filter (single circuit) <input type="checkbox"/> MW26 Max Wattage label, 26W <input type="checkbox"/> MW32 Max Wattage label, 32W <input type="checkbox"/> SYL ⁹ Osram Sylvania Ballast (available only for standard EB option) <input type="checkbox"/> SMT ¹³ Philips Advance SmartMate [®] Ballast	<input type="checkbox"/> STF602H ^{VS} 6" Alzak reflector <input type="checkbox"/> STF602H55 ¹² ^{VSSS} 6" Alzak reflector, 55 Degree Cut-off <hr/> REFLECTOR FINISH <input type="checkbox"/> Blank Specular <input type="checkbox"/> SS Semi-Specular <input type="checkbox"/> MFC ⁷ American Matte [™]	<input type="checkbox"/> Blank Clear Alzak <input type="checkbox"/> CG Champagne Gold Alzak <input type="checkbox"/> BL Black Alzak <input type="checkbox"/> WE Wheat Alzak <input type="checkbox"/> LW Light Wheat Alzak <input type="checkbox"/> PW Pewter Alzak <input type="checkbox"/> BC ^{4,7,10} Painted black cone <input type="checkbox"/> WC ^{4,7,10} Painted white cone <hr/> REFLECTOR OPTIONS <input type="checkbox"/> WT Painted white self-flange <input type="checkbox"/> BB ^{4,7,10} Painted black baffle <input type="checkbox"/> WB ^{4,7,10} Painted white baffle <input type="checkbox"/> WW ⁷ Wall wash reflector <input type="checkbox"/> TRG Trim Ring Gasket (factory installed)	<input type="checkbox"/> B24 Set of two (2) 24" bar hangers for T-bar ceilings <input type="checkbox"/> B6 Set of two (2) bar hangers for ceiling joists up to 24" centers <input type="checkbox"/> FSDFI Fuse kit for field installation <input type="checkbox"/> SCA6D Sloped ceiling adapter (see note on back page) <input type="checkbox"/> Signosó ^{6,10} Architectural glass elements Refer to specification sheets ARCH-SIG-001 through -004 <hr/> LAMP ACCESSORIES <input type="checkbox"/> LP -wattage= 26, 32, or 42 -type= T (Triple 4-pin) -temp=27K, 30K, 35K 41K (Kelvin) *Example: LP32T41K

¹Dimming options not available in 347V.
²Not available with 42W lamps.
³For 26W, 32W, or 42W CFL lamps specify CFT626HEB, CFT632HEB, or CFT642HEB housing and add desired dimming option suffix.
⁴Not available with MFC or semi-specular finishes.
⁵Top access required to service ballast for Chicago Plenum.
⁶Not valid with lensed trim.
⁷Not available with STF602H55 reflector.
⁸Contact Technical Support for availability with CFT632HEB55.
⁹Available for Osram Sylvania Quick 60+[®] Limited Warranty when used with Osram lamp(s). See www.prescolite.com for details.
¹⁰Not available for wall wash
¹¹For 42W specify CFT642HEB ECDM or CFT642HEB55 ECDM
¹²55" option must be chosen on both the housing and reflector
¹³Not available for 347V
¹⁴Not available with CP option



In a continuing effort to offer the best product possible we reserve the right to change, without notice, specifications or materials that in our opinion will not alter the function of the product.
 Web: **www.prescolite.com** • Tech Support: **(888) 777-4832**

ARCH-CFL-001

PHOTOMETRIC DATA

Architektür - 6" Horizontal Triple Open & Wall Wash Downlights - CFT632HEB

BALLAST DATA	26W Triple			32W Triple			42W Triple		
	120V	277V	347V	120V	277V	347V	120V	277V	347V
Total System Watts	28W	28W	38W	35W	35W	42W	44W	47W	48W
Input Current (Amps)	0.23	0.1	0.11	0.29	0.13	0.12	0.36	0.17	0.14
Input Frequency in Hz	50/60	50/60	50/60	50/60	50/60	50/60	50/60	50/60	50/60
Power Factor	>97%	>97%	>97%	>97%	>97%	>97%	>97%	>97%	>97%
Ballast Factor	>98%	>98%	>98%	>98%	>98%	>98%	>98%	>98%	>98%
Total Harmonic Distortion	<10%	<10%	<10%	<10%	<10%	<10%	<10%	<10%	<10%
Minimum Starting Temp.	-18°C (0°F)	-18°C (0°F)	-18°C (0°F)	-18°C (0°F)	-18°C (0°F)	-18°C (0°F)	-18°C (0°F)	-18°C (0°F)	-18°C (0°F)

LAMP DATA (One per fixture)

	26W Triple	32W Triple	42W Triple
Rated Watts	26W Triple	32W Triple	42W Triple
Rates Lumens	1800	2400	3200
Efficacy (LPW)	69	75	76
Rated Life	10,000 hours	10,000 hours	10,000 hours
CRI	82	82	82
Min. Starting Temp.	0° F	0° F	0° F

CFT632HEB-STF602H [Ⓢ]vs with Specular Clear Alzak Reflector

Lamp: One 32W Triple
Spacing Criteria:
0° = 1.5
90° = 1.6
Efficiency: 45.1%

LUMINANCE DATA IN CANDELA/SQ. METER

Angle in Vertical	Average 0°	Average 45°	Average 90°
45°	21019	21096	14312
55°	0	0	0
65°	0	0	0
75°	0	0	0
85°	0	0	0

Test No. PL5221

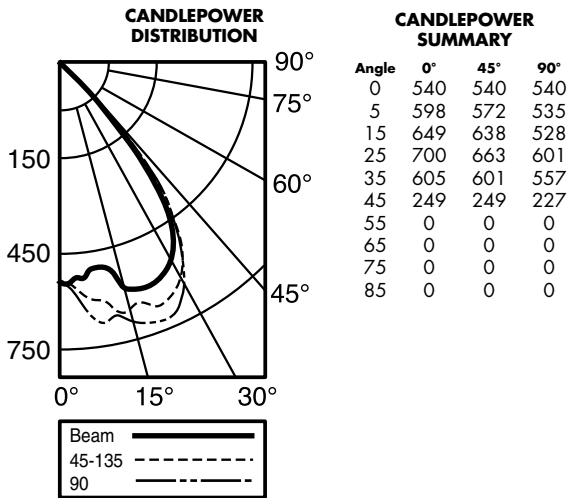

Test No. PL5221

COEFFICIENTS OF UTILIZATION

Zonal Cavity Method

Room Cavity Ratio	% Effective Ceiling Cavity Reflectance				% Effective Floor Cavity Reflectance				% Wall Reflectance				
	80%	70%	50%	30%					70	50	30	10	
	70	50	30	10	70	50	30	10	70	50	30	10	
1	.51	.50	.49	.48	.50	.47	.47	.46	.45	.44			
3	.46	.43	.41	.39	.45	.39	.41	.38	.40	.38			
5	.41	.37	.35	.33	.40	.32	.36	.32	.35	.32			
7	.36	.32	.29	.27	.36	.27	.31	.27	.30	.27			
9	.32	.27	.24	.22	.31	.22	.26	.22	.26	.22			

CFT632HEB-STF602H [Ⓢ]vs Test No. PL5221

NOTES

[Ⓢ]vs Denotes a Virtual Source reflector.

Refer to www.prescolite.com for additional photometric tests (IES Files).

When ordering a sloped ceiling adapter, specify the degree of slope in 5° increments, max. of 35°. For a more precise degree or wet ceiling applications, please contact factory. Sloped ceiling adapter and housing must be installed at the same time.

Note: Use of horizontally-lamped open downlights with amalgam-based CFL lamps in air-handling plenums is not recommended because cool air flow over the lamps will result in reduced light output. Prescolite recommends vertical lamp downlights or use of the regressed lensed trim option for horizontal downlights in these applications to reduce this effect. Refer to Prescolite White Paper WP0003 at www.prescolite.com for more information.



Web: www.prescolite.com • Tech Support: (888) 777-4832
701 Millennium Blvd. • Greenville, SC 29607 U.S.A. • Phone (864) 678-1000
Copyright ©2015 Prescolite, Inc., a division of Hubbell Lighting, Inc. All Rights Reserved • 4/16/15



PHOTOMETRIC DATA

Architektür - 6" Horizontal Triple Open & Wall Wash Downlights - CFT632HEB

CFT632HEB55-STF602H55 with Specular Clear Alzak Reflector

Lamp: One 32W Triple

Spacing Criteria:

0° = 1.5

90° = 1.6

Efficiency: 59.2%

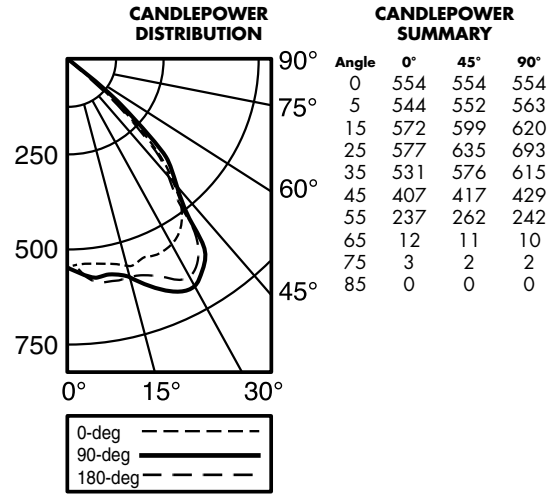

Test No. 2682

LUMINANCE DATA IN CANDELA/SQ. METER

 vs55

Angle in Vertical	Average 0°	Average 90°	Average 180°
45°	34345	36201	35695
55°	24655	25175	21742
65°	1694	1412	1412
75°	692	461	461
85°	0	0	0

Test No. 2682

COEFFICIENTS OF UTILIZATION

Zonal Cavity Method

Room Cavity Ratio	% Effective Ceiling Cavity Reflectance				% Effective Floor Cavity Reflectance					
	80% 70% 50% 30%				20% Effective Floor Cavity Reflectance					
	% Wall Reflectance									
	70	50	30	10	70	10	50	10	50	10
1	.66	.64	.62	.61	.65	.60	.60	.58	.58	.56
3	.57	.52	.48	.45	.56	.45	.50	.44	.48	.44
5	.49	.43	.38	.35	.48	.35	.41	.34	.40	.34
7	.43	.35	.31	.28	.42	.28	.34	.27	.33	.27
9	.37	.30	.25	.22	.36	.22	.29	.22	.28	.22

CFT632HEB55-STF602H55 Test No. 2682

 vs55

AVERAGE INITIAL FOOTCANDLES ON WORKPLANE

Assumptions:

1. Ceiling 80% Wall 50% Floor 20%
2. 4 Luminaires evenly spaced in the center of the room.
3. The room is square and has a width and length equal to twice the luminaire spacing (LS).
4. RCR is Room Cavity Ratio.
5. Dirt and Lumen Depreciation Factors are 1.0
6. Ballast Factor is 1.0 for ballasted fixtures.
7. h_{rc} is height between fixtures and workplane

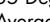
RCR7	Standard Reflector Average Initial  vs	55 Degree Option Average Initial  vs55
LS(FEET)	h_{rc} (FEET)	Footcandles
7.0	10	16
8.0	11	12
9.0	13	9
10.0	14	8

Test No. PL5221/2682

NOTES

 vs Denotes a Virtual Source reflector.

Refer to www.prescolite.com for additional photometric tests (IES Files).

When ordering a sloped ceiling adapter, specify the degree of slope in 5° increments, max. of 35°. For a more precise degree or wet ceiling applications, please contact factory. Sloped ceiling adapter and housing must be installed at the same time.

Note: Use of horizontally-lamped open downlights with amalgam-based CFL lamps in air-handling plenums is not recommended because cool air flow over the lamps will result in reduced light output. Prescolite recommends vertical lamp downlights or use of the regressed lensed trim option for horizontal downlights in these applications to reduce this effect. Refer to Prescolite White Paper WP0003 at www.prescolite.com for more information.



Web: www.prescolite.com • Tech Support: (888) 777-4832

701 Millennium Blvd. • Greenville, SC 29607 U.S.A. • Phone (864) 678-1000

Copyright ©2015 Prescolite, Inc., a division of Hubbell Lighting, Inc. All Rights Reserved • 4/16/15



HUBBELL
Lighting, Inc.