

# HLEML SERIES EXPLOSION-PROOF LED



CAT.#		APPROVALS
JOB	TYPE	

## SPECIFICATIONS

### Applications -

Designed to light classified areas such as paint manufacturing plants, ammunition facilities, oil and gas producing and refining plants, off-shore and dock side installations, tank farms, pipeline pumping stations and marine loading and fuel transfer terminals.

### Construction -

- Specialized thermal management allows up to 55°C ambient temperature ratings
- 120v to 277v universal voltage drivers
- Operating temperature range of -40°C to 55°C
- Fixture weight: 26 lbs. Shipped weight: 30 lbs.

### Optic System -

- HLEML - Fluted globe
- HLEMLC - Clear globe

### LED Light Engine -

- High output LEDs
- 50,000 hours to 70% initial lumens
- 5000°K Color temperature - Crisp white light
- 69 CRI

### LED Driver -

- Circuit Loading Information:
  - 0.5 amps @ 120v
  - 0.2 amps @ 277v
- Power factor greater than 0.90
- THD < 20% @ full load
- FCC 47CFR Part 15 Class B Compliant

### Thermal Performance -

- 40°C TO 55°C

### Listings -

- Class I, Division 1 & 2, groups C & D
- Class I, Zone 1 & 2, groups IIB, IIA
- Class II, Division 1 & 2, groups E, F & G

### Listings Continued . . .

- Class III, Division 1 & 2
- Suitable for wet/marine locations



## DIMENSIONS

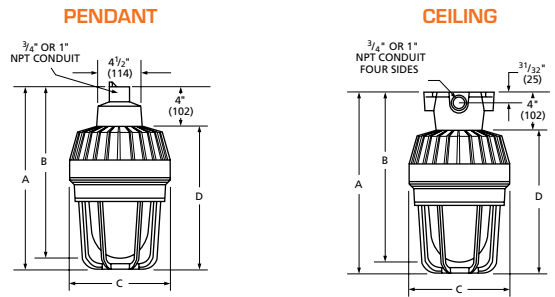

PENDANT	A	B	C	D
	15 15/16"	15 1/16"	8 13/16"	11 15/16"
CEILING	A	B	C	D
	14 5/16"	13 11/16"	7 7/16"	10 5/16"

- NEMA 3, 4, 4X
- Factory Sealed



## ORDERING INFORMATION

ORDERING EXAMPLE: HLEML-4530-A2-G

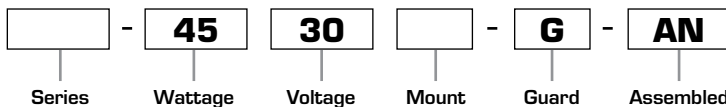

### SERIES

**HLEMLC** Tank w/ Clear Globe  
**HLEML** Tank w/ Fluted Globe

### WATTAGE

**45** 45 Watts

### VOLTAGE

**30** 120 - 277VAC 50/60Hz

### MOUNT

**A2** ¾" Pendant  
**A3** 1" Pendant

**X2** ¾" Ceiling  
**X3** 1" Ceiling  
**B2** ¾" Bracket  
**B3** 1" Bracket  
**D4** 1 ¼" / 1 ½" Stanchion

### GUARD

**G** Guard

### ASSEMBLED

**AN** Assembled

### ACCESSORIES (Order as separate part #)

**ERSD30** Dome Reflector  
**ERA30** Angle Reflector

# HLEML SERIES - EXPLOSION-PROOF LED

## Component Parts / Temperature Data



Pendant



Ceiling



Wall



Stanchion

MOUNTING BRACKETS				
CATALOG NUMBER				HUB SIZE
PENDANT	CEILING	WALL	STANCHION	
EZA2	EZX2	EZB2	-	3/4"
EZA3	EZX3	EZB3	-	1"
-	-	-	EZD4*	1 1/4" / 1 1/2"*

\* 1 1/2" furnished with 1 1/2" - 1 1/4" reducer



EMG2



Factory Sealed Photocell VMHKPC1



ERSD30 Standard Dome



ERA30 Angle Dome



EAC/EACH



EML4530/  
EMLC4530



EMGS3/EMGS2

COMPONENTS	
DESCRIPTION	CATALOG NUMBER
GUARD <sup>1</sup>	EMG2
DOME REFLECTOR <sup>2</sup>	ERSD30
ANGLE REFLECTOR <sup>2</sup>	ERA30
CIDI C2D1 N4X PHOTOCELL 120VAC	VMHKPC1
CIDI C2D1 N4X PHOTOCELL 208-277VAC	VMHKPCC2
REPLACEMENT FLUTED GLOBE & SUPPORT	EMGS3
REPLACEMENT CLEAR GLOBE & SUPPORT	EMGS2

1. Guards are cast of copper-free aluminum with electrostatically applied epoxy/polyester  
2. Reflectors are aluminum with white finish

THERMAL PERFORMANCE DATA					
CATALOG NUMBER	AMBIENT	C1D1/C1Z1	C2D1	L70	SUPPLY WIRE
EML(C)4530	40°C	T6	T4A (EFG)	55,000 HRS	75°C
EML(C)4530	55°C	T5	T4 (EFG)	50,000 HRS	90°C

## PHOTOMETRIC DATA

**LED 45 Watt Fluted Globe Only**

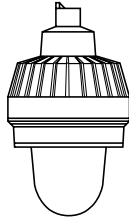

**ZONAL LUMEN SUMMARY**

ZONE	LUMENS - %Lamp	%FIXT
0-30	424 - N.A.	14.7
0-40	720 - N.A.	25.0
0-60	1463 - N.A.	50.8
0-90	2479 - N.A.	86.1
90-120	396 - N.A.	13.7
90-130	400 - N.A.	13.9
90-150	401 - N.A.	13.9
90-180	401 - N.A.	13.9
90-180	2880 - N.A.	100.0

Absolute Photometry  
 Total Luminaire Efficiency = N.A.%  
 Spacing to Mounting Height Ration 1.2

**LED 45 Watt Fluted Globe & Dome Reflector**

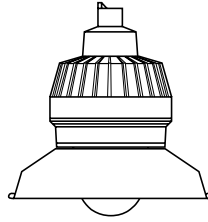

**ZONAL LUMEN SUMMARY**

ZONE	LUMENS - %Lamp	%FIXT
0-30	677 - N.A.	25.1
0-40	1124 - N.A.	41.6
0-60	2164 - N.A.	80.2
0-90	2700 - N.A.	100.0
90-120	0 - N.A.	0.0
90-130	0 - N.A.	0.0
90-150	0 - N.A.	0.0
90-180	0 - N.A.	0.0
90-180	2700 - N.A.	100.0

Absolute Photometry  
 Total Luminaire Efficiency = N.A.%  
 Spacing to Mounting Height Ration 1.2

**LED 45 Watt Fluted Globe & Angle Reflector**

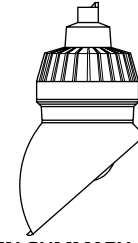

**ZONAL LUMEN SUMMARY**

ZONE	LUMENS - %Lamp	%FIXT
0-30	602 - N.A.	23.7
0-40	943 - N.A.	37.1
0-60	1619 - N.A.	63.7
0-90	2350 - N.A.	92.5
90-120	185 - N.A.	7.3
90-130	190 - N.A.	7.5
90-150	190 - N.A.	7.5
90-180	190 - N.A.	7.5
90-180	2540 - N.A.	100.0

Absolute Photometry  
 Total Luminaire Efficiency = N.A.%  
 Spacing to Mounting Height Ration NA

**LED 45 Watt Fluted Globe & Dome Reflector**

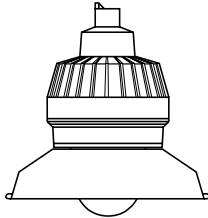

**ZONAL LUMEN SUMMARY**

ZONE	LUMENS - %Lamp	%FIXT
0-30	708 - N.A.	24.9
0-40	1203 - N.A.	42.2
0-60	2299 - N.A.	80.7
0-90	2850 - N.A.	100.0
90-120	0 - N.A.	0.0
90-130	0 - N.A.	0.0
90-150	0 - N.A.	0.0
90-180	0 - N.A.	0.0
90-180	2850 - N.A.	100.0

Absolute Photometry  
 Total Luminaire Efficiency = N.A.%  
 Spacing to Mounting Height Ration 1.3

## DIMENSIONS

**WALL**

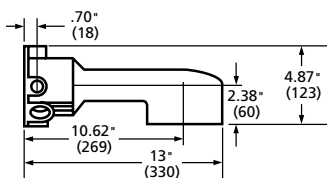
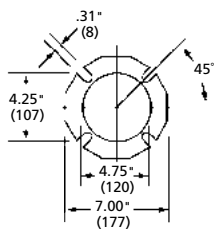
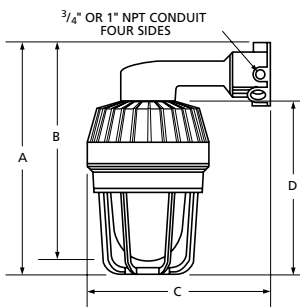

**25° Stanchion**

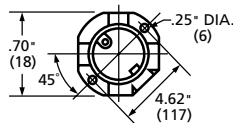
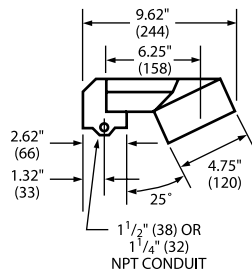
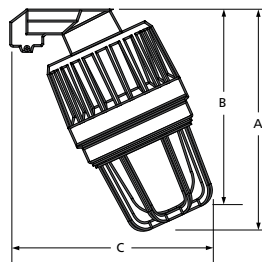

WALL	A	B	C	D
	17"	17"	15"	12"

25° STANCHION	A	B	C
	15"	14"	13 1/2"