



New and Existing Construction

LBS5LEDA

LED Surface Mount with Drop Glass
600 Lumen Module
Wet Location
120V

DATE: _____ TYPE: _____

FIRM NAME: _____

PROJECT: _____

LiteBox 5"



APPLICATIONS:

LiteBox Drop Glass fixture elements are ideal for architectural applications. By combining these elements – cut glass, aluminum and acrylic accents – everyday surface mount lights can be transformed into architectural statements that complement the hard edges of today's trend setting designs. The design of LiteBox Drop Glass fixtures allows the fixture to meet the ambient illumination requirements while providing a luminous focal point. There is no need for a separate decorative fixture; LiteBox Drop Glass combines two systems into one, reducing energy requirements as well as initial installation costs.

LIGHT ENGINE:

High efficacy LED light engine integrated with durable aluminum heat sink for excellent thermal management. 120V, 50/60Hz, powered directly to AC without the need for a driver. Output over-voltage, over-current, and short circuit protection. System designed for optimal life and lumen maintenance (60,000 hours at 70% lumen maintenance per TM-21).

DIMMING:

Continuous dimming to 15% with many LED rated dimmer controls. (See Dimming Notes on pg 3 for recommended dimmers.)

LENS/REFLECTOR:

All LiteBox LED modules are provided standard with a diffuse impact resistant polycarbonate lens for uniform illumination.

INSTALLATION:

Installs onto a standard 4" J-Box.

CERTIFICATIONS:

CSA certified to US and Canadian safety standards. ENERGY STAR qualified. Suitable for wet locations.

WARRANTY:

5 year warranty

See www.prescolite.com for details.

5" LiteBox LED Drop Glass

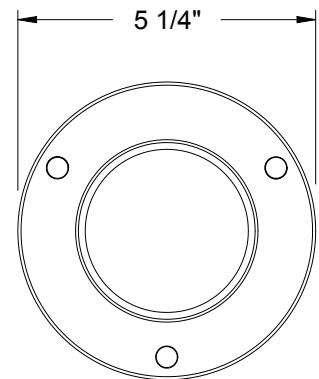
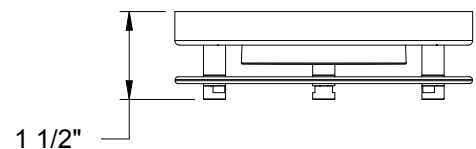

CATALOG NUMBER

EXAMPLE: LBS5LEDA6L30K9 WH DG

TRIM	LED COLOR	CRI	TRIM COLOR	ELEMENT
<input type="checkbox"/> LBS5LEDA6L 5" Round Surface Mount	<input type="checkbox"/> 30K 3000 Kelvin	<input type="checkbox"/> 9 90+ CRI	<input type="checkbox"/> WH White	<input type="checkbox"/> DG Drop Glass

PHOTOMETRIC DATA

LiteBox LED - Surface Mount LED Downlight Modules

ELECTRICAL DATA LB55LEDA6L30K9 DG

Input Voltage	120V AC
Input Frequency	50/60 Hz
Input Current	0.11A
Input Power	12.7W
Power Factor	>0.90
THD	<20%
EMI Filtering	FCC 47CFR Part 15, Class B
Operating Temperature	-30°C to 40°C
Dimming	Yes*
Over-voltage, over-current, short-circuit protected	
*See Dimming Notes for more information	

LB55LEDA6L30K9 WH DG

LED Light Engine: 3000K, 91 CRI
System Wattage: 12.3 W
Fixture Delivered Lumens: 633
Fixture Efficacy: 51.6
Spacing Criteria: 1.2

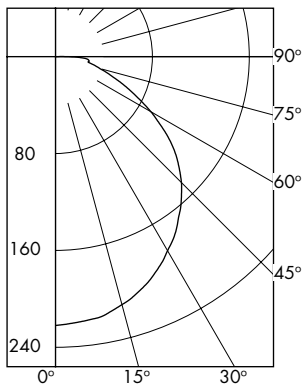

CANDELA DISTRIBUTION	
DEG	CANDELA
0	222
5	220
15	212
25	196
35	174
45	147
55	112
65	70
75	38
85	27
90	18

ZONAL LUMEN SUMMARY		
ZONE	LUMENS	%FIXTURE
0-30	171	27.0
0-40	280	44.2
0-60	493	77.8
0-90	633	100.0

COEFFICIENTS OF UTILIZATION

Room Cavity Ratio	% Effective Ceiling Cavity Reflectance									
	80%		70%		50%		30%			
	20% Effective Floor Cavity Reflectance									
	% Wall Reflectance									
	70	50	30	10	70	10	50	30	50	30
1	108	103	98	94	105	92	96	93	92	89
3	89	79	70	64	87	63	74	67	71	66
5	75	62	53	47	73	46	59	51	57	50
7	65	51	42	36	63	36	49	41	47	40
9	56	43	34	29	55	29	41	34	40	33
10	53	39	31	26	51	26	38	31	37	30

LB55LEDA6L30K9 WH DG

Test No. 15.01335

Test No. 15.01335

Tested at 25°C Ambient in accordance to IESNA LM-79-2008

NOTES

Refer to www.prescolite.com for additional photometric tests (IES Files).



Web: www.prescolite.com • Tech Support: (888) 777-4832
701 Millennium Boulevard • Greenville, SC 29607 U.S.A. • Phone (864) 678-1000
Copyright ©2016 Prescolite, Inc., a division of Hubbell Lighting, Inc. All Rights Reserved
Specifications subject to change without notice. • Printed in U.S.A. • LB-LED-014 9/12/16



HUBBELL
Lighting, Inc.

PHOTOMETRIC DATA

LiteBox LED - Surface Mount LED Downlight Modules

Central Inverters

For full fixture output in back-up mode, we recommend you visit www.dual-lite.com for your Central Lighting Inverter options. Please contact your local Hubbell representative for any assistance with proper sizing and loading of your inverter selection. Central lighting inverters must be ordered separately.

LiteGear: www.dual-lite.com/products/litegear_lg_series

LPS Series: www.dual-lite.com/products/lps

DIMMING NOTES:

Surface Mount LED modules are designed to be compatible with many dimmer controls. Electronic low-voltage rated dimmer controls may offer favorable dimming performance. Incandescent type dimmers are not recommended. The following is a list of known compatible dimmer controls:

Manufacturer	Series	Part Number
Lutron	Diva Series	DVELV-300
Lutron	Maestro Series	MAELV-600
Lutron	Nova T Series	NTELV-300
Lutron	Spacer Series	SPSELV-600
Lutron	Vierti Series	VTELV-600
Leviton	Renoir II	AWRMG-EAW
Leviton	Sure Slide	6615P

Dimming capabilities will vary depending on the dimmer control, load, and circuit installation. Always refer to dimmer manufacturer instructions or a controls specialist for specific requirements.

Dimmer control brand names where identified above are tradenames or registered trademarks of each respective company.

J-Box Mount with Quick Link

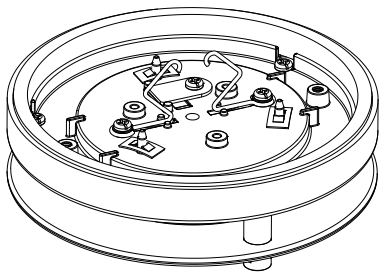

J-Box Adapter

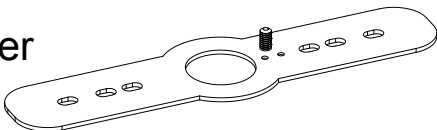

NOTES

Refer to www.prescolite.com for additional photometric tests (IES Files).



Web: www.prescolite.com • Tech Support: (888) 777-4832
701 Millennium Boulevard • Greenville, SC 29607 U.S.A. • Phone (864) 678-1000
Copyright ©2016 Prescolite, Inc., a division of Hubbell Lighting, Inc. All Rights Reserved
Specifications subject to change without notice. • Printed in U.S.A. • LB-LED-014 9/12/16



HUBBELL
Lighting, Inc.