



6" Adjustable Luminaire

LFA6ML

120V-277V
0-10V Dimming

APPLICATIONS:

LiteFrame LFA6ML is a 6" specification grade LED adjustable downlight that utilizes high efficiency LEDs to obtain color consistency, energy savings, and low maintenance costs. 50,000 hours minimum life up to 35°C (95°F) in open plenum applications.

HOUSING:

One-piece 22 gauge non-corrosive steel platform. Pre-wired j-box with snap-on cover for easy access. Ships with light engine installed. Approve for 8 (4 in/4 out) No. 12 AWG conductors rated for 90°C through wiring. (CP excluded, see line art on page 2).

REFLECTOR:

6" lower reflector includes stainless steel trim retention torsion springs standard. Trim flanges are made of diecast aluminum standard, but are available with a self-flange option (ST). Reflectors are Alzak which will not yellow, crack, or warp. All trims feature translating center beam optics, 35° vertical aiming and 362° rotational aiming. Hot aiming (with trim in place) standard for all trims. Both vertical and horizontal adjustments can be locked in place without tools. Upper Reflector is standard clear alzak.

LED LIGHT ENGINE:

The LFA6ML uses the Philips Fortimo DLM LED Module. This module provides controlled color consistency (3 SDCM) from fixture to fixture. The system is designed for optimal life and lumen maintenance (>50,000 hours at 70% lumen maintenance). Both reflector and light engine assembly are mechanically retained to housing.

LED DRIVER:

The LFA6ML utilizes the Philips Fortimo LED Driver specifically designed to optimize efficiency of the Fortimo DLM Module. Driver is designed to match the 50,000 hour minimum life expectancy of the system. Meets UL Class 2, inherent short circuit protection, self limited, overload protected. If critical temperatures are reached on driver or LED module, integrated thermal feedback loop will gradually reduce current to protect system life. Driver is universal 120V-277V. Optional Lutron Series A driver is also available.

DIMMING:

Comes standard with 0-10V dimming capability. Flicker-free dimming to 10%. 0-10V control may consume up to 1mA. 0-10V, Lutron 2 wire and EcoSystem dimming available to 1% and DMX with RDM (remote device management) dimming to less than 0.1%.

INSTALLATION:

Adjustable Bar hangers included (not with CP option). Universal adjustable mounting brackets also accept 1/2" EMT conduit or 1 1/2" or 3/4" lathing channel (by others) or Prescolite 24" bar hangers (B24 or B6).

CERTIFICATIONS:

CSA certified to US and Canadian safety standards. Suitable for damp locations. Approved for through wiring. Non-IC rated.

WARRANTY:

5 year warranty. See www.prescolite.com for details.

DATE: _____ TYPE: _____

FIRM NAME: _____

PROJECT: _____

LiteFrame®

Ceiling Cutout: 6-3/4"
Maximum Ceiling Thickness 1-1/4"
For conversion to millimeters,
multiply inches by 25.4
Not to Scale

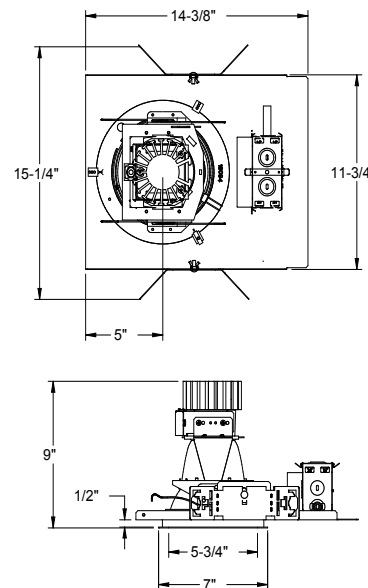

See page 2 for CP line art

CATALOG NUMBER:

EXAMPLE: LFA6ML-6LFAML30L35K8WH

Order housing, reflector, and accessories separately

HOUSING	DRIVER OPTION	VOLTAGE OPTION	LIGHT ENGINE	KELVIN	TRIM	REF. FINISH OPTIONS	LOWER REF. COLOR OPTIONS	TRIM OPTIONS	ACCESSORIES
<input type="checkbox"/> LFA6ML Medium Lumen Adjustable 0-10V 10% dimming 120-277V	Standard 0-10V 10% Dimming <input type="checkbox"/> DM1⁹ 0-10V dimming at 1%, 120-277V <input type="checkbox"/> EDM^{2,3} Hi-Lume 1% EcoSystem LED Driver <input type="checkbox"/> 2DM^{2,3} Hi-Lume 1% 2-wire LED Driver (120V only) <input type="checkbox"/> DMX^{2,3} DMX with RDM dimming to <0.1%	Standard 120V-277V <input type="checkbox"/> 120 120V <input type="checkbox"/> 277 277V <input type="checkbox"/> 347 347V <div>HOUSING OPTION</div> <input type="checkbox"/> CP^{2,6,7,10} Chicago Plenum	<input type="checkbox"/> 6LFAML30L Upper is clear specular reflector with 3000 Lumen Module	<input type="checkbox"/> 27K 2700 Kelvin <input type="checkbox"/> 30K 3000 Kelvin <input type="checkbox"/> 35K 3500 Kelvin <input type="checkbox"/> 40K 4000 Kelvin <input type="checkbox"/> 50K 5000 Kelvin <div>CRI</div> <input type="checkbox"/> 8 80+ CRI <input type="checkbox"/> 9 90+ CRI <div>BEAM ANGLE</div> <input type="checkbox"/> WFL45¹ Spun Aluminum Specular Clear Alzak Upper Reflector	<input type="checkbox"/> 6C3 Alzak Reflector <input type="checkbox"/> 6B3^{1,4,5} Baffle <input type="checkbox"/> 6L1^{1,4,5} Etched Lens Shower Trim <div>FLANGE OPTIONS</div> <input type="checkbox"/> ST Self Flanged (6C3 Only)	Standard Semi-Diffuse <input type="checkbox"/> SS Semi-Specular <input type="checkbox"/> MFC American Matte <input type="checkbox"/> SP Specular <input type="checkbox"/> V Kurt Versen Specular <input type="checkbox"/> VS Kurt Versen Softglow® <input type="checkbox"/> VSS Kurt Versen SoftSheen™	Standard Clear Alzak <input type="checkbox"/> CG Champagne Gold Alzak <input type="checkbox"/> GD Gold Alzak <input type="checkbox"/> BL Black Alzak <input type="checkbox"/> WE Wheat Alzak <input type="checkbox"/> LW Light Wheat Alzak <input type="checkbox"/> PW Pewter Alzak <input type="checkbox"/> WH Painted Matte White Reflector and Flange <input type="checkbox"/> BC Painted Black Reflector and Flange	<input type="checkbox"/> WT Painted White Flange <input type="checkbox"/> BAT⁵ Brushed Aluminum Trim Flange <input type="checkbox"/> BT Painted Black Flange <input type="checkbox"/> ZT Painted Zet Silver Flange <div>Notes:</div> <ol style="list-style-type: none"> Not available with color/finish options. Specular finish only. Not available with 347V Voltage must be specified with EDM, 2DM and DMX. Not available in Alzak colors Not available with ST option Bar hanger accessory should be selected with CP housing, not included as standard Not available with DMX See Central Inverter compatibility note and web links on page 2 For DM1, do not specify a voltage if 120 or 277 See CP lineart on page 2 for limited adjustable angles 	<input type="checkbox"/> B24⁶ Set of two 24" bar hangers for T-bar ceilings <input type="checkbox"/> B6⁶ Set of two (2) bar hangers for ceiling joist up to 24" centers <input type="checkbox"/> LiteGear⁸ Inverter, single phase central lighting, 125VA-250VA <input type="checkbox"/> LPS Series⁸ LitePower micro-inverter, 20VA-55VA

PHOTOMETRIC DATA

LiteFrame - 6" LFA6ML Adjustable

DRIVER DATA

6LFA6ML30L

Input Voltage	120-277V
Input Frequency	50/60 Hz
Input Current	0.273A (120V) 0.118A (277V)
Input Power	32.7W
Power Factor	≥0.90
THD	<20%
EMI Filtering	FCC 47CFR Part 15, Class A
Operating Temperature	-20°C to 35°C
Dimming	0-10V
Over-voltage, over-current, short-circuit protected	

*Power consumption and photometric output may vary slightly with various driver and CRI options.

Lumen Multiplier Table

Photometrics published below are for the 3000K, 80 CRI. This table may be used to approximate the lumen values at different Kelvin temperatures and CRI.

4000 Kelvin	1.07
3500 Kelvin	1.00
3000 Kelvin	1.00
2700 Kelvin	0.95

80 CRI.....	1.00
90 CRI.....	0.91

Delivered Lumens

The table below shows the delivered lumens for the various lumen outputs.

Output	CRI	Distribution	Delivered Lumens	Input Watts	Lumens Per Watt	Full Catalog String
30L	80	45	2832	32.7	87	LFA6ML-6LFA30L30K8WFL45

Dimming Compatibility Table

Dimming Ballast	Manufacturer	Web Link
DM/DM1	Lutron DTV	http://bit.ly/11jSvZg
DM/DM1	Leviton AWRMG-7xx, AWSMG-7xx, AWSMT-7xx	http://bit.ly/2mvXqlW
EDM	Lutron	http://bit.ly/1vtjHAL
2DM	Lutron	http://bit.ly/1S4WjXK

DMX

See instruction sheet on www.prescolite.com for connection & installation information.

Other useful links: <http://www.eldoled.com/led-drivers/powerdrive/50-watt/ac-561s/>

Central Inverters

For full fixture output in back-up mode, we recommend you visit www.dual-lite.com for your Central Lighting Inverter options. Please contact your local Hubbell representative for any assistance with proper sizing and loading of your inverter selection. Central lighting inverters must be ordered separately.

LiteGear: www.dual-lite.com/products/litegear_lg_series

LPS Series: www.dual-lite.com/products/lps

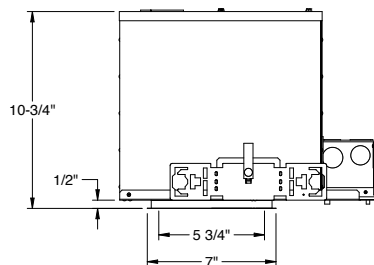
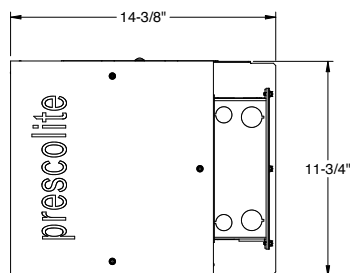

LFA6ML CP

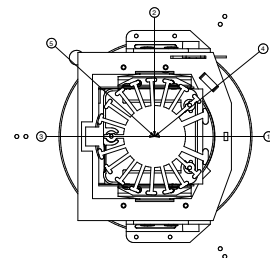

- 1: 29.5°
- 2: 26°
- 3: 20°
- 4: 35°
- 5: 29°



Web: www.prescolite.com • Tech Support: (888) 777-4832
 701 Millennium Boulevard • Greenville, SC 29607 U.S.A. • Phone (864) 678-1000
 Copyright ©2018 Prescolite, Inc., a division of Hubbell Lighting, Inc. All Rights Reserved
 Specifications subject to change without notice. • Printed in U.S.A. • LFR-LED-053 • 01/07/19

