



4" LED Downlight

LC4SLPH

POWERHUBB™
PoE LIGHTING & CONTROL Enabled
1000/1400/1800 Lumens

APPLICATIONS:

LiteFrame Commercial LC4SL is a 4" commercial grade LED downlight with available outputs between 1000-1800 lumens. PowerHUBB™ enables Hubbell Lighting's portfolio of commercial, industrial and architectural luminaires to further reduce energy consumption and total cost of ownership for simple to complex Power over Ethernet environments. Rated for a minimum of 50,000 hours life (70% lumen maintenance) with ambient plenum temperatures up to 35°C (10L), 28°C (14L), 25°C (18L). Free Air Flow around the fixture is required for optimal life performance. This product is not recommended for use with 3rd party "FIREHAT" or insulation barriers.

HOUSING:

One-piece 22 gauge non-corrosive steel platform. Pre-wired J-box with snap-on cover for easy access. Snap-in connection from driver compartment allows easy installation of light engine/trim assembly and can be upgraded to accommodate technology improvements. Approved for 8 (4 in/4 out) No. 12 AWG conductors rated for 90°C through wiring.

REFLECTOR:

High purity aluminum, Alzak, iridescence suppressed, semi-diffuse reflector. Self-trim standard. Painted white self-trim (WT) available as option.

LED LIGHT ENGINE:

The LC4SL uses mid power LEDs, specifically mixed to provide a minimum of 80 CRI with 3 SDCM color consistency. The use of multiple mid power LEDs allows for optimal thermal management by effectively spreading the heat over a larger area and eliminating hot spots on the LEDs. A diffuse, yet highly transmissive lens obscures the view of the LEDs and creates a smooth, even look from below. The light engine is available in multiple Kelvin temperatures and the system is designed to provide optimal life and lumen maintenance (50,000 hours at 70% lumen maintenance). The reflector/light engine assembly is mechanically retained to the housing.

POWERHUBB™:

Hubbell Control Solutions' PowerHUBB™ is an enterprise-level Power over Ethernet (PoE) lighting and control platform that seamlessly integrates luminaires, sensors, user interfaces and software for a scalable intelligent building control solution. PowerHUBB™ PoE Lighting and Control options provide low-voltage wired connectivity for Power over Ethernet network system deployment.

DIMMING:

Dimming to 1% standard, See the PowerHUBB technical sheet for more details.

INSTALLATION:

Light commercial bar hangers included. Universal adjustable mounting brackets also accept 1/2" EMT conduit or 1 1/2" or 3/4" lathing channel (by others) or Prescolite 24" bar hangers (B24 or B6). Wall wash orientation may be field adjusted in 90° increments to housing.

CERTIFICATIONS:

CSA certified to US and Canadian safety standards. Suitable for wet locations (WW damp location). This product qualifies as a "designated country construction material" per FAR 52.225-11 Buy American-Construction. Materials under Trade Agreements effective 6/10/2020. See [Buy American Solutions](#).

WARRANTY:

5 year warranty. See [www.prescolite.com](#) for details.

DATE: _____ TYPE: _____

FIRM NAME: _____

PROJECT: _____

LiteFrame®



See Certification Specifications

Ceiling Cutout: 5" Maximum Ceiling Thickness 5/8" For conversion to millimeters, multiply inches by 25.4 Not to Scale

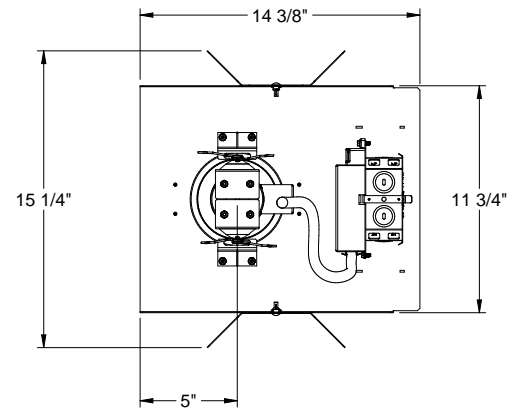
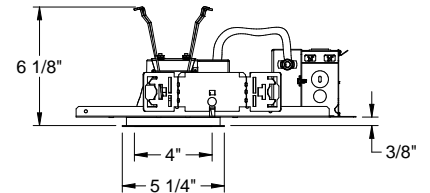

Order housing, reflector, and accessories separately

CATALOG NUMBER:

EXAMPLE: LC4SLPHM-4LCSL14L35K9WT

HOUSING		POWERHUBB™ NODE	TRIM APERTURE	OUTPUT	KELVIN	CRI	REF. FINISH/COLOR OPTION	REFLECTOR OPTIONS	ACCESSORIES
<input type="checkbox"/>	LC4SLPH Standard Lumen PowerHUBB™ Enabled	<input type="checkbox"/> PM PowerHUBB™, On/Off/1% Dim, Master <input type="checkbox"/> PMC PowerHUBB™, On/Off/1% Dim, Control Inputs, Master <input type="checkbox"/> PS PowerHUBB™, On/Off/1% Dim, Satellite <input type="checkbox"/> PSC PowerHUBB™, On/Off/1% Dim, Control Inputs, Satellite	<input type="checkbox"/> 4LCSL Standard Lumen Clear Alzak Reflector	<input type="checkbox"/> 10L 1000 Lumen <input type="checkbox"/> 14L 1400 Lumen <input type="checkbox"/> 18L 1800 Lumen	<input type="checkbox"/> 27K 2700 Kelvin <input type="checkbox"/> 30K 3000 Kelvin <input type="checkbox"/> 35K 3500 Kelvin <input type="checkbox"/> 40K 4000 Kelvin <input type="checkbox"/> 50K 5000 Kelvin	<input type="checkbox"/> 8 80+ CRI <input type="checkbox"/> 9 90+ CRI	<input type="checkbox"/> WH Painted Matte White Reflector and Flange	<input type="checkbox"/> WT Painted White Flange Only <input type="checkbox"/> WF Wide Flange <input type="checkbox"/> WW ¹ Wall Wash <input type="checkbox"/> IP65 ² Flush Lens, IP65/66 rated <input type="checkbox"/> VR ² Vandal Resistant Flush Lens, IP65/66 rated	<input type="checkbox"/> B24 Set of two(2) 24" bar hangers for T-bar ceilings <input type="checkbox"/> B6 Set of two (2) bar hangers for ceiling joist up to 24" centers

¹ Damp location only.

² IP65 and VR cannot be chosen together, not compatible with WT or WF.



A Division of Hubbell Lighting, Inc.

In a continuing effort to offer the best product possible we reserve the right to change, without notice, specifications or materials that in our opinion will not alter the function of the product. Web: [www.prescolite.com](#) • Tech Support: (888) 777-4832

LFR-LED-058

PHOTOMETRIC DATA

LiteFrame - 4" LC4SLPH Downlight

ELECTRICAL DATA	4LCSL10Lxxx	4LCSL14Lxxx	4LCSL18Lxxx
Input Power	14W	19W	23W
Constant Current Output	700mA	700mA	700mA
EMI Filtering	FCC 47CFR Part 15, Class A	FCC 47CFR Part 15, Class A	FCC 47CFR Part 15, Class A
Operating Temperature	0°C to +35°C	0°C to +28°C	0°C to +25°C
Dimming	1%	1%	1%
Over-voltage, over-current, short-circuit protected			

Lumen Multiplier Table

Photometrics for the LC4 are published below at a nominal 3500 Kelvin temperature. This table may be used to approximate the lumen values at different Kelvin temperatures. Power consumption would stay the same.

5000 Kelvin	1.09
4000 Kelvin	1.00
3500 Kelvin	1.00
3000 Kelvin	0.99
2700 Kelvin	0.96

LC4SLPHPM-4LCSL18L35K8

LED Light Engine: 3500K, 80+ CRI
System Wattage: 23W
Fixture Delivered Lumens: 1865
Fixture Efficacy: 81.0
Spacing Criteria: 1.0

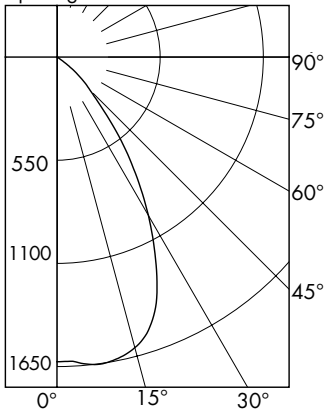

CANDELA DISTRIBUTION

DEG	CANDELA
0	1624
5	1641
15	1604
25	1256
35	694
45	249
55	46
65	2
75	1
85	0
90	0

ZONAL LUMEN SUMMARY

ZONE	LUMENS	%LUMINAIRE
0-60	1860	99.8
0-90	1865	100.0
90-180	0	0.0
0-180	1865	100.0

LUMINANCE DATA IN CANDELA/SQ. METER

Angle in Vertical	Average
45°	43435
55°	9892
65°	584
75°	477
85°	0

COEFFICIENTS OF UTILIZATION Zonal Cavity Method

Room Cavity Ratio	% Effective Ceiling Cavity Reflectance																
	80%		70%		50%		30%		10%								
	70	50	30	10	70	50	30	10	50	30	10						
20% Effective Floor Cavity Reflectance																	
% Wall Reflectance																	
1	113	110	108	105	111	108	106	104	104	102	100	100	99	97	97	96	95
2	107	102	98	94	105	100	96	93	97	94	91	94	91	89	91	89	87
3	101	94	89	85	99	93	88	84	90	86	83	88	84	82	86	83	80
4	96	88	82	77	94	86	81	77	84	80	76	82	78	75	80	77	74
5	90	81	75	71	89	80	75	70	79	74	70	77	73	69	75	72	68
6	85	76	70	65	84	75	69	65	74	68	64	72	67	64	71	67	63
7	81	71	64	60	79	70	64	60	69	63	59	68	63	59	66	62	59
8	76	66	60	56	75	66	60	56	65	59	55	64	59	55	63	58	55
9	73	62	56	52	71	62	56	52	61	55	51	60	55	51	59	54	51
10	69	59	52	48	68	58	52	48	57	52	48	56	51	48	56	51	48

LC4SLPHPM-4LCSL18L35K8

Test No. R17.01300-01

Test No. R17.01300-01

Tested at 25°C Ambient in accordance to IESNA LM-79-2008

LC4SLPHPM-4LCSL14L35K8

LED Light Engine: 3500K, 80+ CRI
System Wattage: 19W
Fixture Delivered Lumens: 1443
Fixture Efficacy: 75.9
Spacing Criteria: 1.0

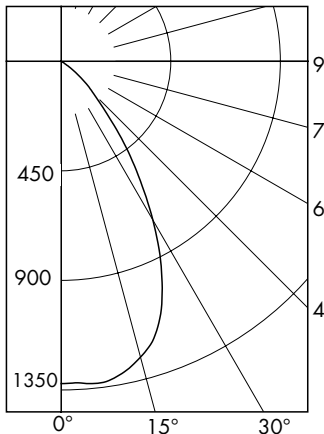

CANDELA DISTRIBUTION

DEG	CANDELA
0	1324
5	1329
15	1258
25	978
35	525
45	188
55	34
65	2
75	1
85	0
90	0

ZONAL LUMEN SUMMARY

ZONE	LUMENS	%LUMINAIRE
0-60	1439	99.7
0-90	1443	100.0
90-180	0	0.0
0-180	1443	100.0

LUMINANCE DATA IN CANDELA/SQ. METER

Angle in Vertical	Average
45°	32794
55°	7312
65°	584
75°	477
85°	0

COEFFICIENTS OF UTILIZATION Zonal Cavity Method

Room Cavity Ratio	% Effective Ceiling Cavity Reflectance																
	80%		70%		50%		30%		10%								
	70	50	30	10	70	50	30	10	50	30	10						
20% Effective Floor Cavity Reflectance																	
% Wall Reflectance																	
1	113	110	108	105	111	108	106	104	104	102	101	100	99	98	97	96	95
2	107	102	98	94	105	100	97	93	97	94	91	94	92	89	91	89	87
3	101	95	89	85	99	93	88	84	91	86	83	88	85	82	86	83	81
4	96	88	82	78	94	87	81	77	84	80	76	82	78	75	81	77	74
5	91	82	76	71	89	81	75	71	79	74	70	77	73	69	76	72	69
6	86	76	70	65	84	75	69	65	74	69	65	72	68	64	71	67	64
7	81	71	65	60	80	71	65	60	69	64	60	68	63	60	67	63	59
8	77	67	60	56	76	66	60	56	65	60	56	64	59	55	63	59	55
9	73	63	56	52	72	62	56	52	61	56	52	60	55	52	59	55	52
10	69	59	53	49	68	59	53	49	58	52	49	57	52	48	56	52	48

LC4SLPHPM-4LCSL14L35K8

Test No. R17.01301-01

Test No. R17.01301-01

Tested at 25°C Ambient in accordance to IESNA LM-79-2008



Web: www.prescolite.com • Tech Support: (888) 777-4832
701 Millennium Boulevard • Greenville, SC 29607 U.S.A. • Phone (864) 678-1000
Copyright ©2018 Prescolite, Inc., a division of Hubbell Lighting, Inc. All Rights Reserved
Specifications subject to change without notice. • Printed in U.S.A. • IFRLED-058 • 01/11/21



PHOTOMETRIC DATA

LiteFrame - 4" LC4SLPH Downlight

LC4SLPHPM-4LCSL10L35K8

LED Light Engine: 3500K, 80+ CRI
 System Wattage: 14W
 Fixture Delivered Lumens: 1062
 Fixture Efficacy: 75.8
 Spacing Criteria: 0.9

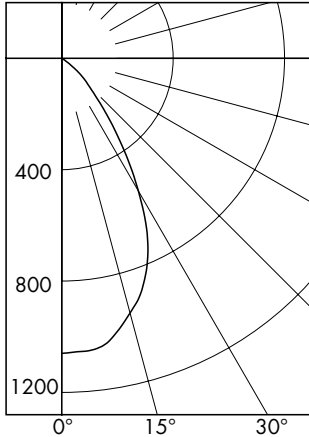

CANDELA DISTRIBUTION

DEG	CANDELA
0	1060
5	1055
15	947
25	731
35	367
45	133
55	24
65	1
75	0
85	0
90	0

Test No. R17.01302-01

Tested at 25°C Ambient in accordance to IESNA LM-79-2008

ZONAL LUMEN SUMMARY

ZONE	LUMENS	%LUMINAIRE
0-60	1060	99.8
0-90	1062	100.0
90-180	0	0.0
0-180	1062	100.0

LUMINANCE DATA IN CANDELA/SQ. METER

Angle in Vertical	Average
45°	23200
55°	5161
65°	292
75°	0
85°	0

COEFFICIENTS OF UTILIZATION Zonal Cavity Method

Room Cavity Ratio	% Effective Ceiling Cavity Reflectance				% Effective Floor Cavity Reflectance				% Wall Reflectance								
	80%		70%		50%		30%		10%		10%						
	70	50	30	10	70	50	30	10	50	30	10	50	30	10			
1	113	110	108	106	111	108	106	104	104	102	101	100	99	98	97	96	95
2	107	102	98	95	105	101	97	94	97	94	91	94	92	90	92	89	88
3	102	95	90	86	100	94	89	85	91	87	84	88	85	82	86	83	81
4	96	88	82	78	94	87	82	78	85	80	77	83	79	76	81	78	75
5	91	82	76	72	89	81	76	71	79	74	71	78	73	70	76	72	69
6	86	77	70	66	85	76	70	66	74	69	65	73	68	65	72	68	64
7	82	72	66	61	80	71	65	61	70	65	61	69	64	60	67	63	60
8	77	67	61	57	76	67	61	57	66	60	56	65	60	56	64	59	56
9	73	63	57	53	72	63	57	53	62	57	53	61	56	53	60	56	52
10	70	60	54	50	69	59	53	50	58	53	49	58	53	49	57	52	49

LC4SLPHPM-4LCSL10L35K8

Test No. R17.01302-01

LC4SLPHPM-4LCSL14L35K8 WW

LED Light Engine: 3500K, 80+ CRI
 System Wattage: 19W
 Fixture Delivered Lumens: 1477
 Fixture Efficacy: 77.7

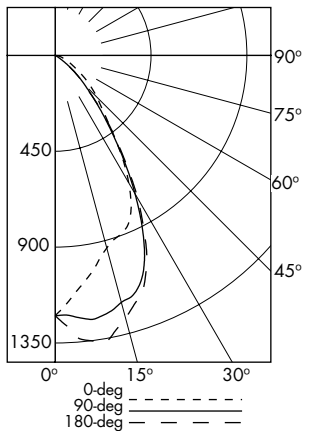

CANDELA DISTRIBUTION

DEG	0	90	180
0	1222	1222	1222
5	1115	1235	1336
15	936	1200	1276
25	834	990	1016
35	510	509	526
45	277	198	193
55	143	43	41
65	65	7	4
75	29	4	3
85	6	0	0
90	0	0	0

Test No. R17.02507-01

Tested at 25°C Ambient in accordance to IESNA LM-79-2008

LUMINANCE DATA IN CANDELA/SQ. METER

Angle in Vertical	0 DEG	90 DEG	180 DEG
45°	48301	34526	33654
55°	30740	9244	8814
65°	18964	2042	1167
75°	13916	1906	1429
85°	8488	0	0

MULTIPLE UNITS			
1'	2'	3'	4'
UNITS ON 3' CENTER	UNITS ON 3' CENTER	UNITS ON 4' CENTER	UNITS ON 4' CENTER

2' DISTANCE FIXTURE MOUNTED OUT FROM WALLS FOOTCANDLE DISTRIBUTION ON WALL SURFACE (DIRECT ONLY)

DISTANCE FROM CEILING IN FEET	15	8	2	1	0	14	9	14	14	4	14
1	24	17	6	1	0	27	22	27	25	11	25
2	24	17	8	3	1	30	25	30	26	16	26
3	18	15	9	4	2	26	26	26	21	18	21
4	11	10	8	4	2	20	21	20	15	16	15
5	7	7	6	4	2	16	17	16	12	13	12
6	5	5	4	3	2	13	13	13	9	10	9
7	3	3	3	3	2	11	10	10	8	8	8
8	2	2	2	2	2	9	9	9	7	7	7
9											

LC4SLPHPM-4LCSL14L35K8WW

Test No. R17.02507-01

PowerHUBB™ POWERHUBB™

Hubbell Control Solutions' PowerHUBB™ is an enterprise-level Power over Ethernet (PoE) lighting and control platform that seamlessly integrates luminaires, sensors, user interfaces and software for a scalable intelligent building control solution.

See separate [PowerHUBB™ In-Fixture Solutions Guide](#) and [Hubbell Control Solutions PowerHUBB Brochure](#) for more details.



Web: www.prescolite.com • Tech Support: (888) 777-4832
 701 Millennium Boulevard • Greenville, SC 29607 U.S.A. • Phone (864) 678-1000
 Copyright ©2018 Prescolite, Inc., a division of Hubbell Lighting, Inc. All Rights Reserved
 Specifications subject to change without notice. • Printed in U.S.A. • LFR-LED-058 • 01/11/21

