

CONTACTOR P/N	BLOWOUT COIL & STATIONARY CONTACT P/N
58871-001	58852-102
58871-002	58852-101
58871-003	58852-102
58871-004	58852-101

NOTE: WHEN ORDERING REPLACEMENT PARTS BE SURE TO FURNISH SERIAL NUMBER AND CATALOG NUMBER WHICH ARE LOCATED ON THE NAMEPLATE. ALSO GIVE PART NUMBER & DESCRIPTION.

ITEM	DESCRIPTION	PART NO.	QTY.
1	#8-32 X .62 LG. ROUND HEAD SCREW	47241-104	2
2	#8 SPLIT LOCK WASHER	47252-064	2
3	BLOWOUT COIL & STATIONARY CONTACT ASSEMBLY (25 AMP BLOWOUT COIL)	58852-102	1
3	BLOWOUT COIL & STATIONARY CONTACT ASSEMBLY (50 AMP BLOWOUT COIL)	58852-101	1
4	.250-20 X 1.125 LG. STUD	66475-035	1
5	.250 SPLIT LOCK WASHER	47252-038	3
6	.250-20 HEX NUT	47253-021	1
7	#10 BRASS FLAT WASHER	47251-008	2
8	BASE ASSEMBLY	58875-001	1
9	LOCKOUT COIL	19971-001	1
10	STATOR ASSEMBLY	58663-000	1
11	OPERATING COIL	19970-000	1
12	.312-18 X 1.37 LG. STUD	57439-010	1
13	OPERATING COIL CORE	58660-001	1
14	CORE CAP	21440-000	1
15	.250-20 X .62 LG. FILLISTER HEAD SCREW	47244-147	1
16	OPERATING SPRING	08778-000	1
17	.250-20 X .375 LG. HEX HEAD SCREW	47246-059	2
18	SPRING ADJUSTING BRACKET	42960-000	1
19	.312-24 HEX NUT	47253-204	1
20	ADJUSTING SCREW	42899-000	1
21	ARMATURE ASSEMBLY	58878-000	1
22	ARMATURE HINGE PIN	18581-000	1
23	#10-32 BRASS HEX NUT	47254-009	1
24	#10 EXTERNAL TOOTH LOCK WASHER	47303-006	1
25	#10-32 X .37 LG. PAN HEAD SEMS SCREW	49137-083	1
26	FINGER BOARD	42005-000	1
27	FINGER SPRING	04657-000	1
28	MOVABLE FINGER	05722-000	1
29	SHUNT	04873-001	1
30	LOCKOUT COIL CORE	58880-000	1
31	.500 EXTERNAL RETAINING RING	57429-012	1
32	ARC SHIELD ASSEMBLY	42856-001	1
33	.250-20 X 1.50 LG. BRASS STUD	57438-039	2
34	.250 BRASS FLAT WASHER (3)	47251-041	4
35	.250-20 BRASS HEX NUT (3)	47254-011	6
36	PLUNGER AUXILIARY PARTS KIT	68011-003	A/R
37	#8-32 X 2.06 LG. ROUND HEAD SCREW (NOT SHOWN)	47241-261	A/R
38	#8 SPLIT LOCK WASHER (NOT SHOWN)	47252-006	A/R
39	AUXILIARY ASSEMBLY (NOT SHOWN)	67976-001	A/R
40	ARC HORN	49029-000	1
41	SPACER	58876-000	1
42	STATIONARY CONTACT SUPPORT	58661-002	1
43	BLOWOUT COIL INSULATOR	42014-000	2
44	BLOWOUT COIL CORE	42024-000	1
45	#10-24 X .37 LG. S.S. HEX HEAD SCREW	47779-042	2
46	#10 SPLIT LOCK WASHER	47252-065	2
47	STATIONARY CONTACT	02317-000	1
48	.250 BRASS FLATWASHER, .500 O.D.	47251-050	1
49	BRASS CUP WASHER	81279-061	1

NOTE: FOR ITEM 3, CHOOSE ONLY 1 ITEM (SEE CHART)

NOTE: AUXILIARY CONTROL CONTACT ASSEMBLY TO BE ORDERED SEPARATELY, REFER TO PRINT B-68011. AUXILIARY CONTROL CONTACT ASSEMBLY IS NOT INCLUDED WITH COMPLETE CONTACTOR ASSEMBLY.

INCLUDED ON ITEM 3 BLOWOUT & STATIONARY CONTACT ASSEMBLY

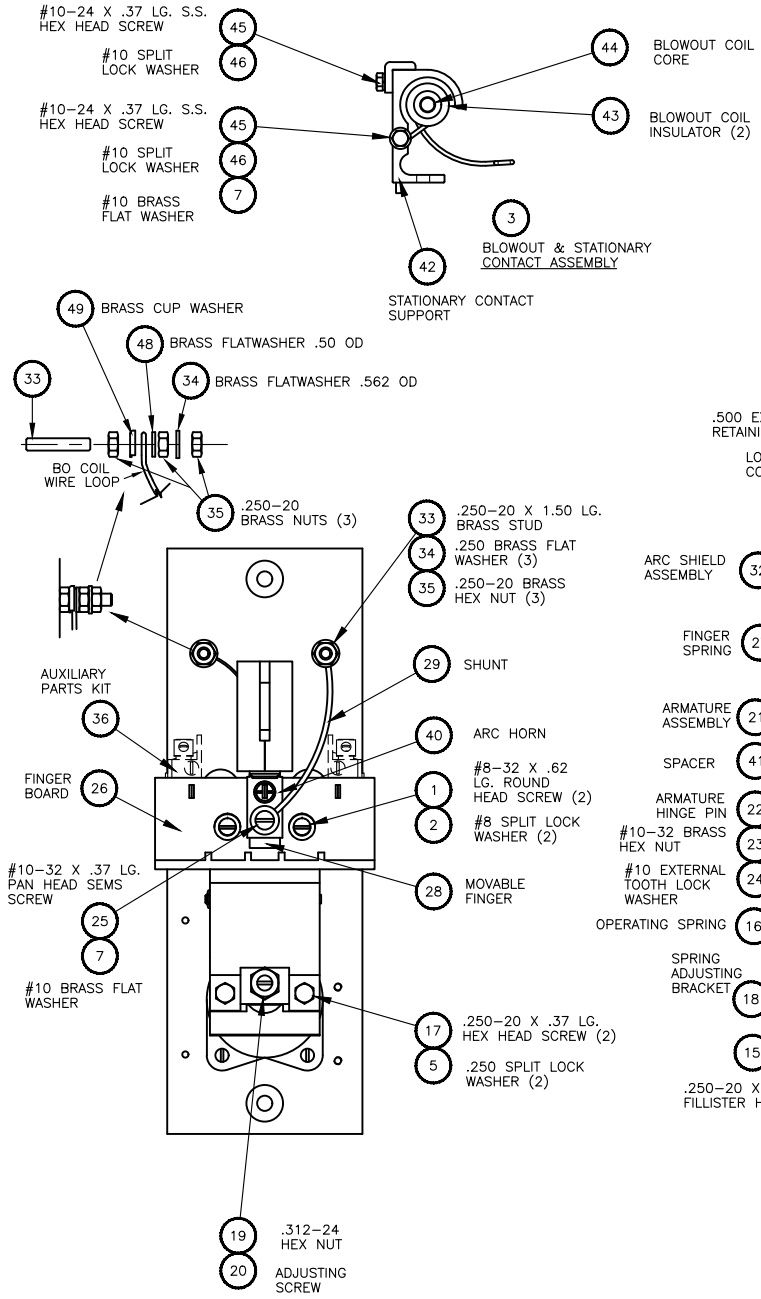

THIS DRAWING FILE AND THE DATA SHOWN IS PROPRIETARY AND CONFIDENTIAL AND THE SOLE PROPERTY OF HUBBELL INDUSTRIAL CONTROLS. DO NOT USE OR REPRODUCE WITHOUT WRITTEN APPROVAL OF HUBBELL.

E 061719	LMH	ADD ITS 48 & 49 ECN A18-054	LINEAR	HOLE	ANGLES	SIZE 2 NC CONTACTOR RENEWAL PARTS BULLETIN 50 AMP DC BULL 5210
D 4-17-00	TLJ	REDRAWN TO CAD	0.X = ±.050	PUNCH ±.002	DIMEN. ± 1°	
C 9-27-99	RR	WAS 68040-003	0.XX = ±.020	±.50	UNDIM. 90° ±2°	
B 1-6-99	LMH	WAS 04873-000	0.XXX = ±.005	BEAM SPECIFIED		
A 10-26-99	PJS	ECN 5210-181	CADD NO. 58871001	R.M.S.	DATE 10-9-79	DR.DON K CK. REF.
Rev	DATE	BY	DESCRIPTION	Hubbell Industrial Controls, Inc. 4301 Cheyenne Dr., Archdale, NC 27283		DRG. NO. 1 OF 1 RPC-58871-1