

Primary Volts	Connect Primary Lines To	Inter-Connect	Connect Secondary Lines To
216	H1-H10	H1 to H9 H10 to H2	
228	H1-H10	H1 to H8 H10 to H3	
240	H1-H10	H1 to H7 H10 to H4	
252	H1-H10	H1 to H6 H10 to H5	
432	H1-H10	H2 to H9	
444	H1-H10	H3 to H9	
456	H1-H10	H3 to H8	
468	H1-H10	H4 to H8	
480	H1-H10	H4 to H7	
492	H1-H10	H5 to H7	
504	H1-H10	H5 to H6	
Secondary Volts			
240		X2 to X3	X1-X4
120/240		X2 to X3	X1-X3-X4
120		X1 to X3 X2 to X4	X1-X4

.28 X .88 SLOT FOR .25 HARDWARE

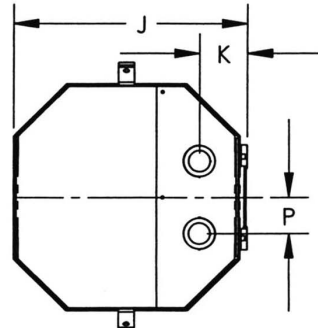

BOTTOM



Type No.

KVA	CATALOG NUMBER	VOLTAGE		NEMA	WEIGHT	PHASE	FREQ.
		HIGH	LOW				
25	TC-53518-3S	240x480	120/240	3R	250	1φ	60 Hz

TYPICAL PERFORMANCE DATA

Winding Rise	115°C
Insulation	180°C
Sound Level	45 dB

Windings:	CU	IMPEDANCE	
-----------	----	-----------	--

Typical Efficiency	
Full Load Losses	
No Load Losses	

A	B	C	D	E	F	G	H	J	K	L	M	N	P	R
16.13	17.43	16.06	13.34	4.58	13.75	18.44	13.63	13.13	2.68	2.44	3.00	3.13	2.00	3.00

DRAWN: ADR